



# TAI-SAW TECHNOLOGY CO., LTD.

No. 3, Industrial 2nd Rd., Ping-Chen Industrial District,  
Taoyuan, 324, Taiwan, R.O.C.

TEL: 886-3-4690038 FAX: 886-3-4697532

E-mail: [tstsales@mail.taisaw.com](mailto:tstsales@mail.taisaw.com) Web: [www.taisaw.com](http://www.taisaw.com)

## Approval Sheet For Product Specification

Issued Date: 2004/07/30

Product Name: SAW Filter 163 MHz

TST Parts No.: TA0168A

Customer Parts No.:

Company: _____
Division: _____
Approved by : _____
Date: _____

Checked by: \_\_\_\_\_ Asin Lin

Approval by: \_\_\_\_\_ Francis Chen

Date: \_\_\_\_\_ 2004/07/30



# TAI-SAW TECHNOLOGY CO., LTD.

No. 3, Industrial 2nd Rd., Ping-Chen Industrial District,  
Taoyuan, 324, Taiwan, R.O.C.

TEL: 886-3-4690038 FAX: 886-3-4697532

E-mail: [tstsales@mail.taisaw.com](mailto:tstsales@mail.taisaw.com) Web: [www.taisaw.com](http://www.taisaw.com)

## SAW Filter 163 MHz

MODEL NO.: TA0168A

Rev. No.:2

### A. MAXIMUM RATING:

1. Input Power Level: 0 dB<sub>m</sub>
2. DC voltage: 10 V
3. Operating Temperature: -10°C to +50°C
4. Storage Temperature: -40°C to +85°C

RoHS Compliant  
Lead free  
Lead-free soldering

### B. ELECTRICAL SPECIFICATION:

Characteristics	Specification	Note
Center frequency, $F_c$ (MHz)	163	1
Insertion Loss, <b>I.L.</b> (Within $F_c \pm 4$ MHz) (dB)	6.5 Max.	1
Amplitude Ripple, <b>A.R.</b> (Within $F_c \pm 4$ MHz) (dB)	2.1 Max.	
Attenuation: (Reference level from 0 dB) (dB)		
$F_c - 100$ MHz to $-38.8$ MHz (dB)	50 Min.	1
$F_c + 38.8$ MHz to $+ 100$ MHz (dB)	42 Min.	
Impedance at $F_c$ ; Input $Z_{IN} = R_{IN} // C_{IN}$	390 $\Omega$ // 300 pF	2
Output $Z_{OUT} = R_{OUT} // C_{OUT}$	1164 $\Omega$ // 374 pF	2

Note1. The standard definitions is in JIS C 6703

Note2.

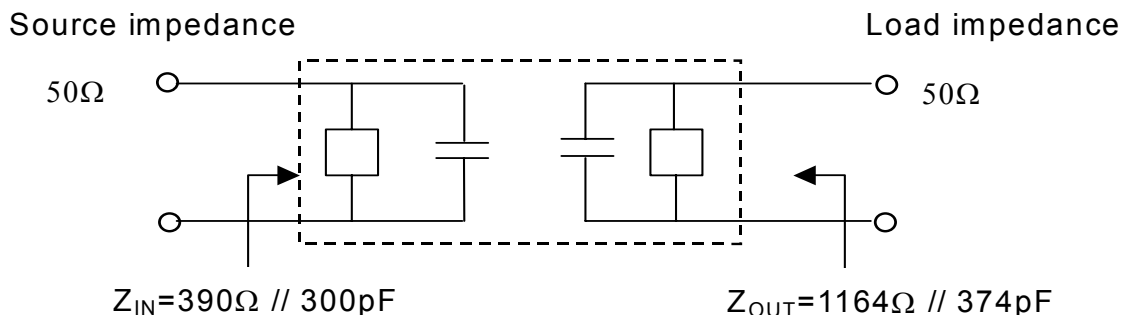

**C.FREQUENCY CHRACTERISTICS:**

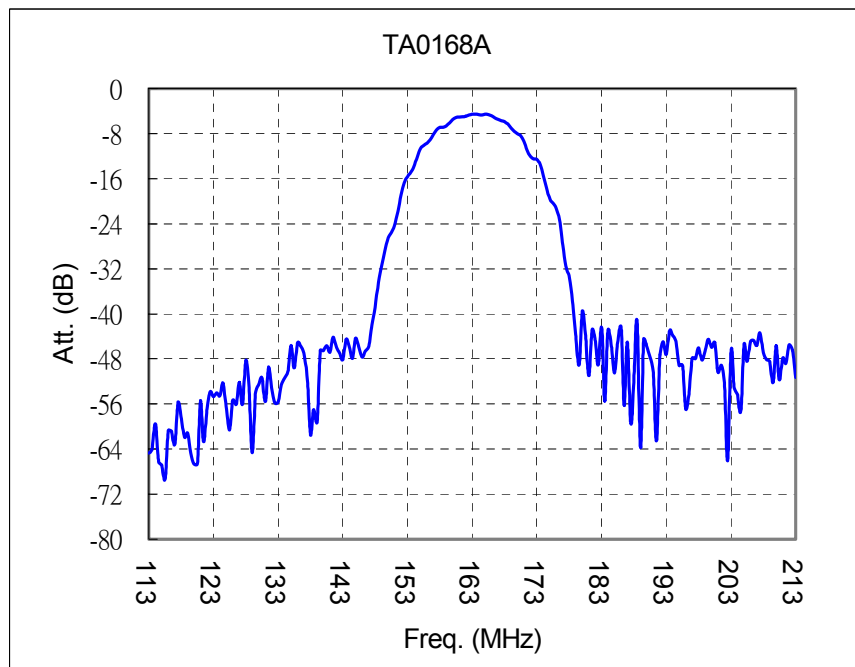
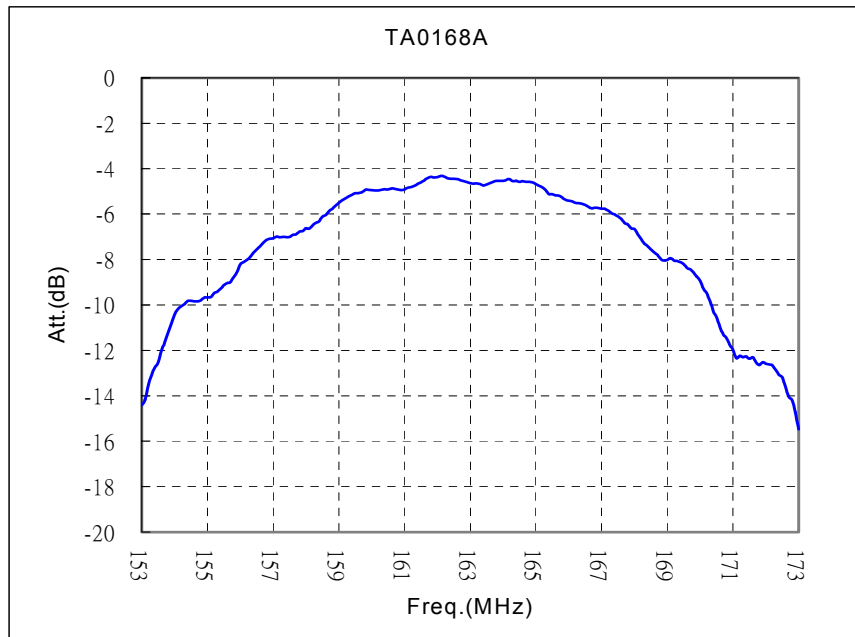

**D. MEASUREMENT CIRCUIT:**

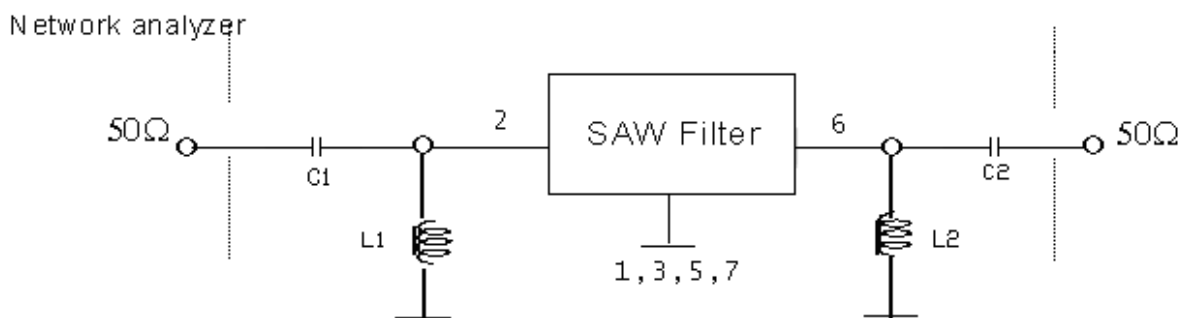

C1 = 12 pF    L1 = 47 nH  
 C2 = 8 pF    L2 = 47 nH

**E. OUTLINE DRAWING:**

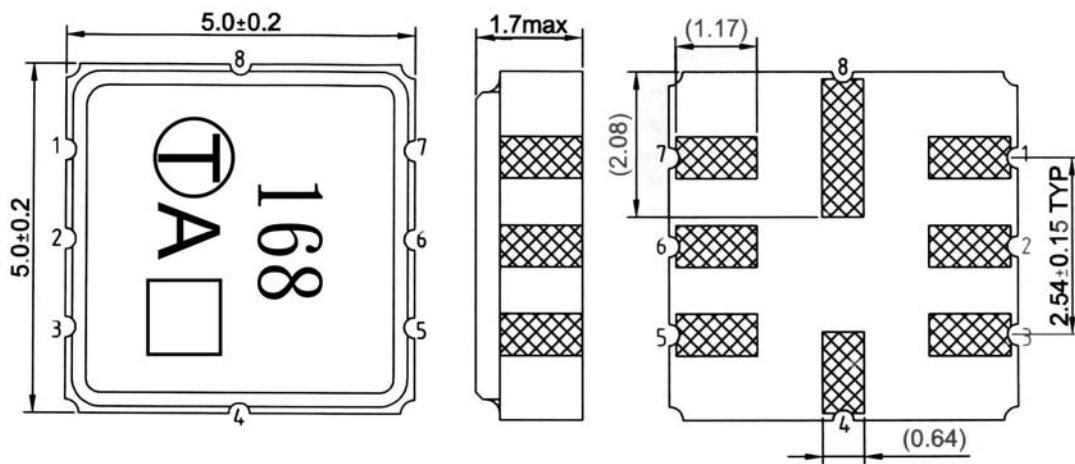

#2 : Input or Output  
 #6 : Output or Input  
 #4、8 : Case Ground  
 #1、3、5、7 : Ground  
 □ : Date code  
 Unit : mm

## F. PACKING:

### 1. REEL DIMENSION

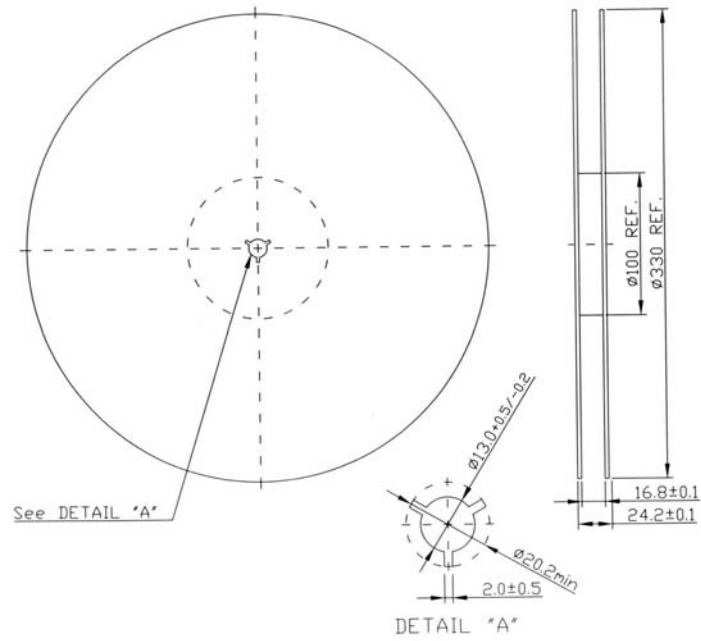

### 2. TAPE DIMENSION

