



# TAI-SAW TECHNOLOGY CO., LTD.

No. 3, Industrial 2nd Rd., Ping-Chen Industrial District,  
Taoyuan, 324, Taiwan, R.O.C.

TEL: 886-3-4690038 FAX: 886-3-4697532

E-mail: [tstsales@mail.taisaw.com](mailto:tstsales@mail.taisaw.com) Web: [www.taisaw.com](http://www.taisaw.com)

## Approval Sheet For Product Specification

Issued Date:

Product Name: SAW Filter 169MHz SMD 5.0×5.0 mm

TST Parts No.:TA0437A

Customer Parts No.:\_\_\_\_\_

Company:_____
Division:_____
Approved by :_____
Date:_____

Checked by:\_\_\_\_\_ Elvis Chiu

Approval by:\_\_\_\_\_ Francis Chen

Date:\_\_\_\_\_ 2005/03/29



# TAI-SAW TECHNOLOGY CO., LTD.

No. 3, Industrial 2nd Rd., Ping-Chen Industrial District,  
Taoyuan, 324, Taiwan, R.O.C.

TEL: 886-3-4690038 FAX: 886-3-4697532

E-mail: [tstsales@mail.taisaw.com](mailto:tstsales@mail.taisaw.com) Web: [www.taisaw.com](http://www.taisaw.com)

## SAW Filter 169 MHz

MODEL NO.: TA0437A

REV. NO.:1

### A. MAXIMUM RATING:

1. Input Power Level: 10 dB<sub>m</sub>
2. DC voltage: 3 V
3. Operating Temperature: -10°C to +70°C
4. Storage Temperature: -40°C to +85°C

RoHS Compliant  
Lead free  
Lead-free soldering

### B. ELECTRICAL CHARACTERISTICS:

Item		Specification				
		Unit	Min.	Typ.	Max.	
Center Frequency	F <sub>c</sub>	MHz	-	169	-	
Insertion Loss	IL <sub>min</sub> (reference level)	dB	-	1.5	2.8	
Bandwidth	BW <sub>-3dB</sub>	MHz	6	8.8	-	
Absolute Attenuation(reference to IL <sub>min</sub> dB)						
	F <sub>c</sub> -50 ~ F <sub>c</sub> -30	MHz	dB	42	54	-
	F <sub>c</sub> -30 ~ F <sub>c</sub> -15	MHz	dB	36	52	-
	F <sub>c</sub> +30 ~ F <sub>c</sub> +50	MHz	dB	40	51	-
Source impedance	Z <sub>s</sub>	Ω	-	50	-	
Load impedance	Z <sub>L</sub>	Ω	-	50	-	

Note: IL<sub>min</sub> is the minimum of the pass band attenuation. The center frequency F<sub>c</sub> is the mean value of the upper and lower frequencies at the 3dB filter attenuation level relative to the IL<sub>min</sub>.

### C. Frequency Characteristics :

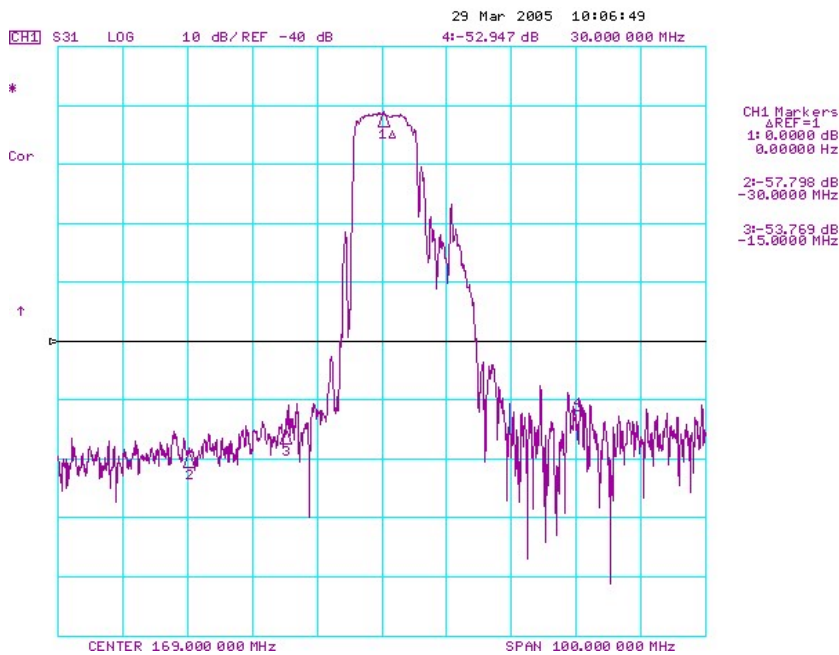
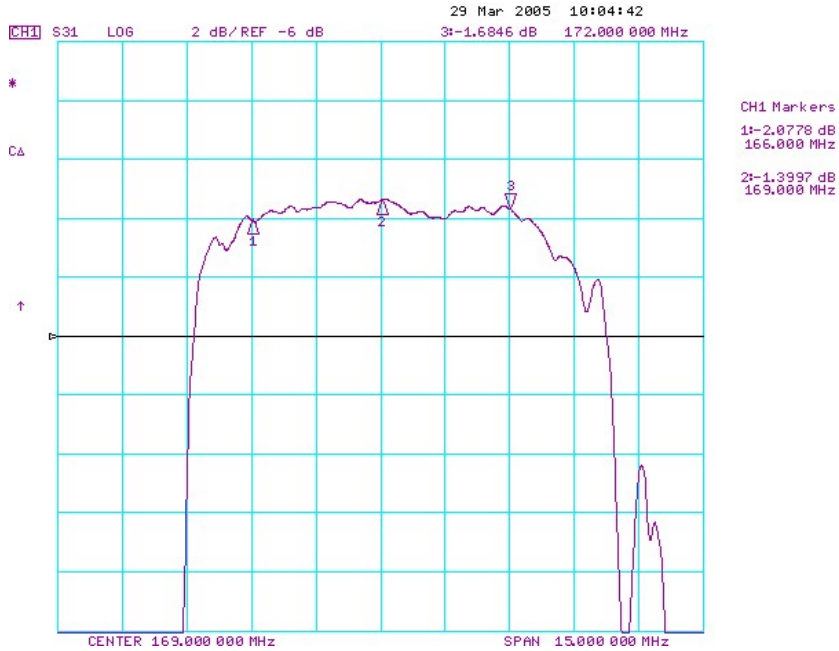

**D. MEASUREMENT CIRCUIT:**

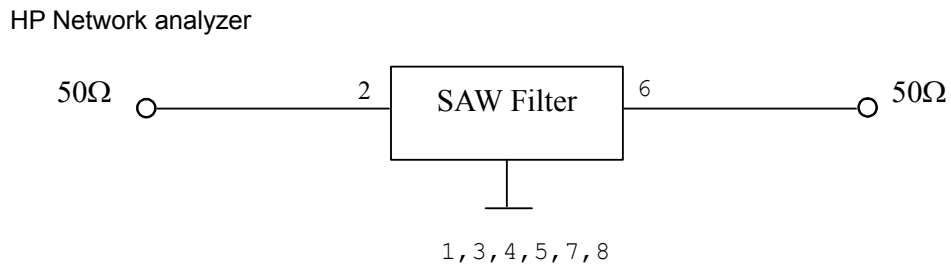

**E. OUTLINE DRAWING:**

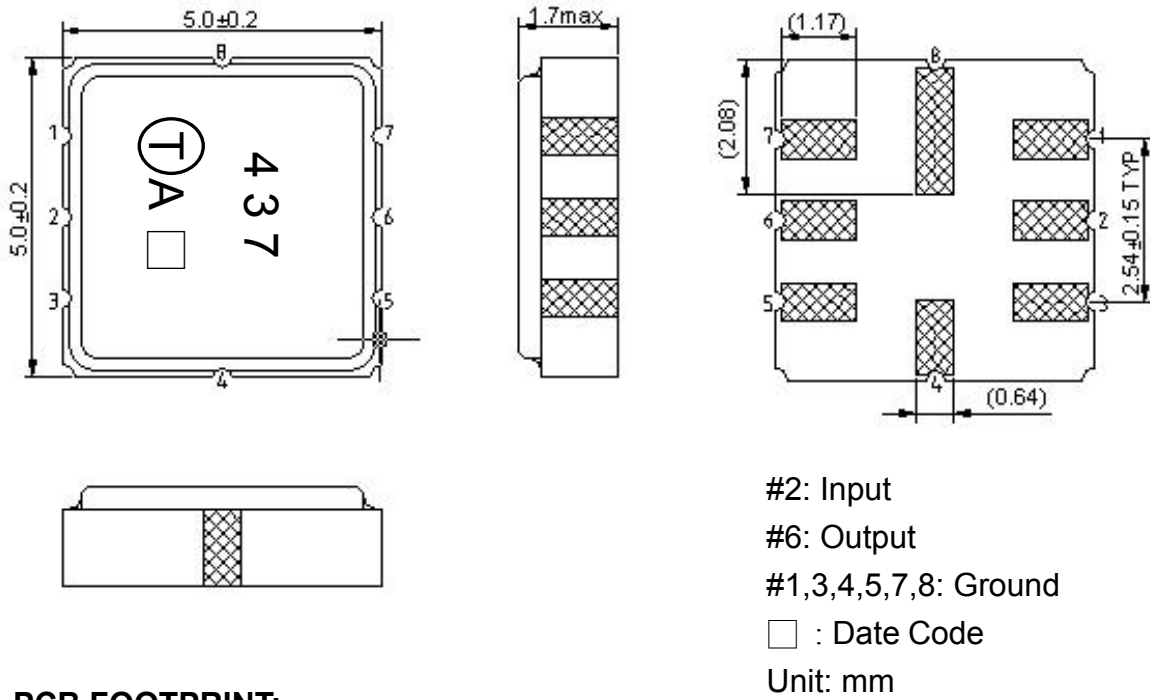

**F. PCB FOOTPRINT:**

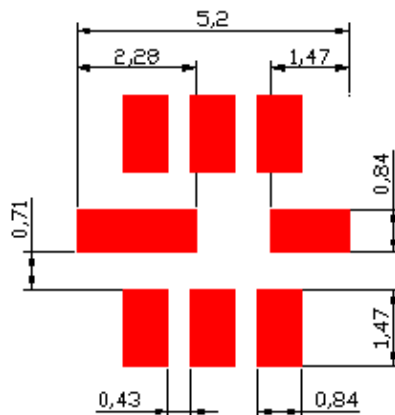

## G. PACKING:

### 1. REEL DIMENSION

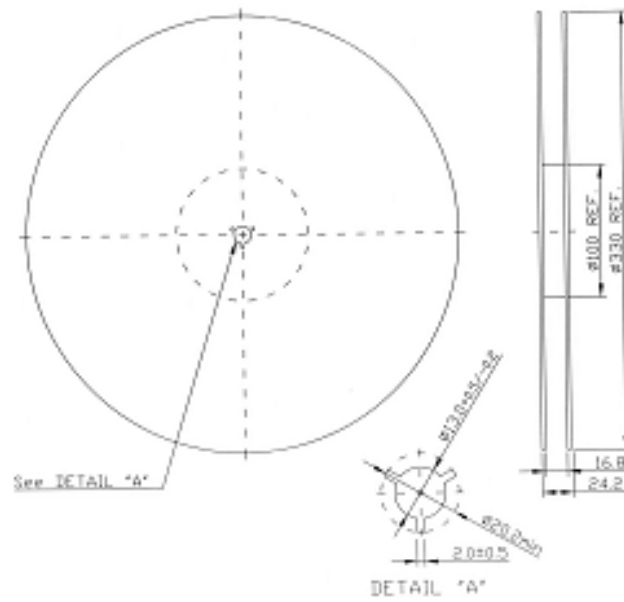

### 2. TAPE DIMENSION

