



# TAI-SAW TECHNOLOGY CO., LTD.

No. 3, Industrial 2nd Rd., Ping-Chen Industrial District,  
Taoyuan, 324, Taiwan, R.O.C.

TEL: 886-3-4690038 FAX: 886-3-4697532

E-mail: [tstsales@mail.taisaw.com](mailto:tstsales@mail.taisaw.com) Web: [www.taisaw.com](http://www.taisaw.com)

## Product Specification Approval Sheet

Product Name: SAW Filter 940.5MHz SMD 3.0×3.0mm(BW=39 MHz)

TST Parts No.:TA0460C

Customer Parts No.: \_\_\_\_\_

Customer signature required
Company: _____
Division: _____
Approved by : _____
Date: _____

Checked by: \_\_\_\_\_ Anne Chen *Anne Chen*

Approved by: \_\_\_\_\_ Andy Yu *Andy Yu*

Date: \_\_\_\_\_ 2018.10.04

1. Customer signed back is required before TST can proceed with sample build and receive orders.
2. Orders received without customer signed back will be regarded as agreement on the specifications.
3. Any specifications changes must be approved upon by both parties and a new revision of specifications shall be released to reflect the changes.



# TAI-SAW TECHNOLOGY CO., LTD.

No. 3, Industrial 2nd Rd., Ping-Chen Industrial District,  
Taoyuan, 324, Taiwan, R.O.C.

TEL: 886-3-4690038 FAX: 886-3-4697532

E-mail: [tstsales@mail.taisaw.com](mailto:tstsales@mail.taisaw.com) Web: [www.taisaw.com](http://www.taisaw.com)

## SAW Filter 940.5 MHz

MODEL NO.: TA0460C

REV. NO.:1

### A. MAXIMUM RATING:

1. Input Power Level: 10 dB<sub>m</sub>
2. DC voltage: 3 V
3. Operating Temperature: -40°C to +85°C
4. Storage Temperature: -40°C to +85°C
5. Moisture Sensitivity Level: Level 1
6. ESD 100V(MM) 200V(HBM)

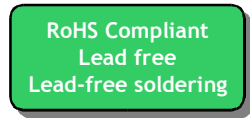

Electrostatic Sensitive Device (ESD)

### B. ELECTRICAL CHARACTERISTICS:

Characteristics				Specification			Note
				Min.	Typ.	Max	
Center frequency	Fc	MHz	-	940.5	-	-	
Insertion loss	921~960 MHz	I.L.	dB	-	3.2	4.9	-
Ripple	921~960 MHz		dB	-	1.5	2.6	-
VSWR	921~960 MHz			-	2.0	2.8	
<b>Attenuation: ( Reference level from 0 dB )</b>							
	0 ~ 800 MHz		dB	45	60	-	-
	800 ~ 880 MHz		dB	38	47	-	-
	880 ~ 902 MHz		dB	31	42	-	-
	981 ~ 985 MHz		dB	16	27	-	-
	985 ~ 1005 MHz		dB	20	28	-	-
	1005 ~ 1025 MHz		dB	28	33	-	-
	1025 ~ 1760 MHz		dB	40	50	-	-
	1760~ 2300 MHz		dB	30	39	-	-
	2300 ~ 3000 MHz		dB	20	27	-	-
Source Impedance				50Ω			1
Load Impedance				50Ω			1

Note1. No matching network required for operation at 50Ω

**C. TRANSFER FUNCTION :**

□

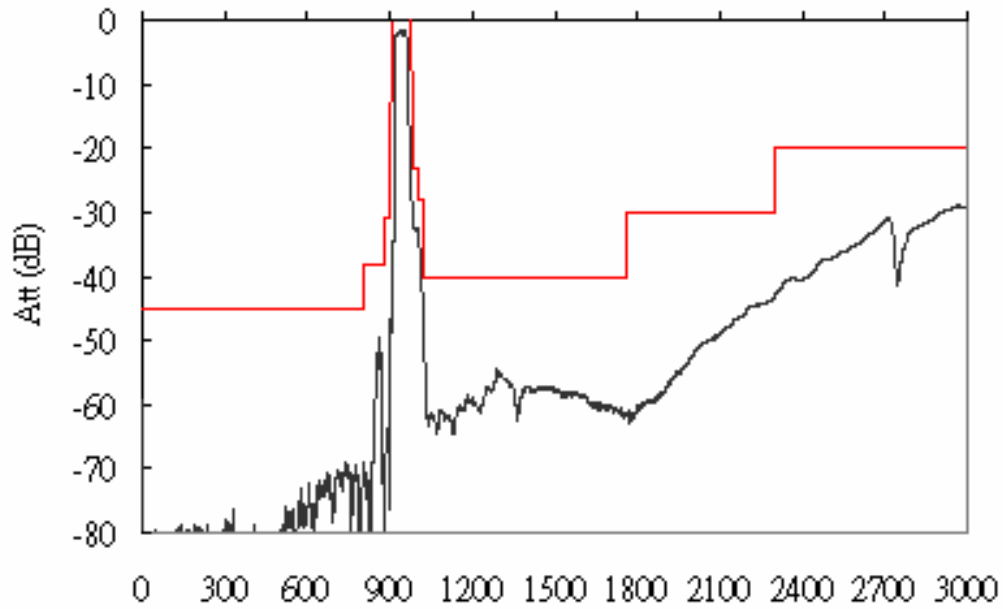
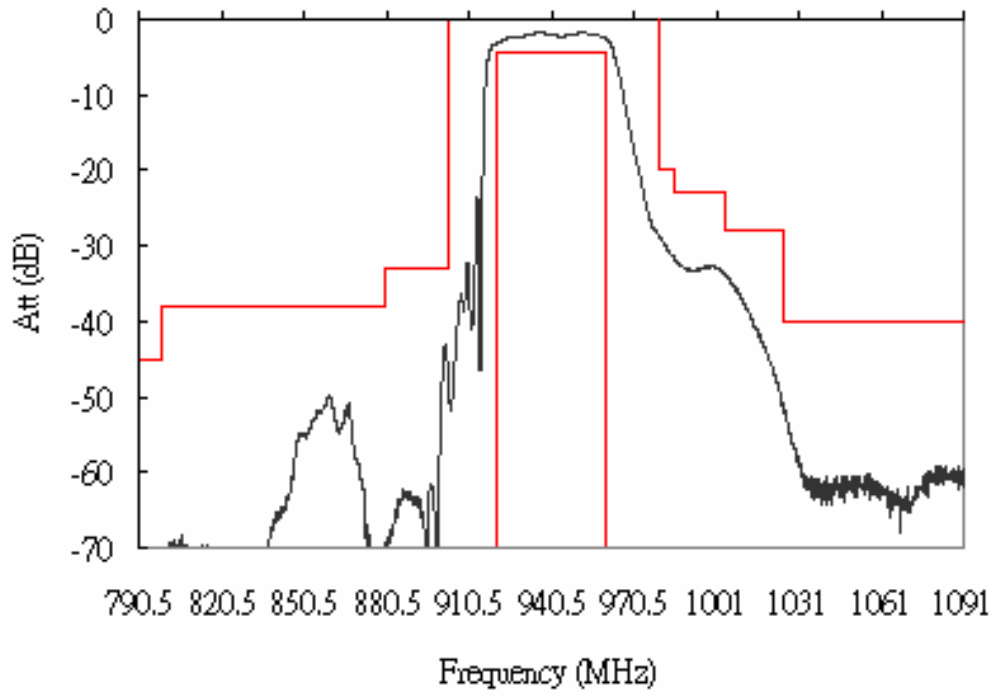

**REFLECTION FUNCTION:**

**S11**

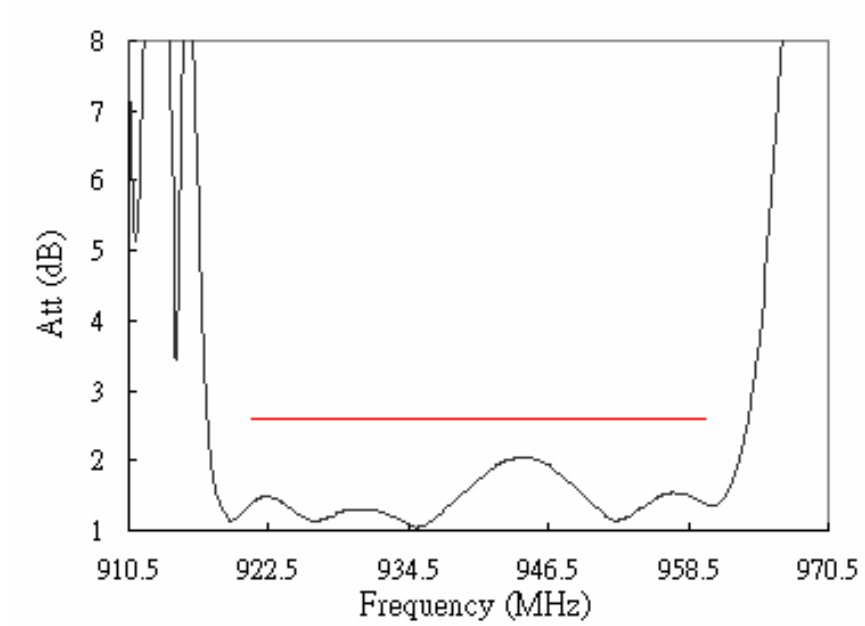

**S22**

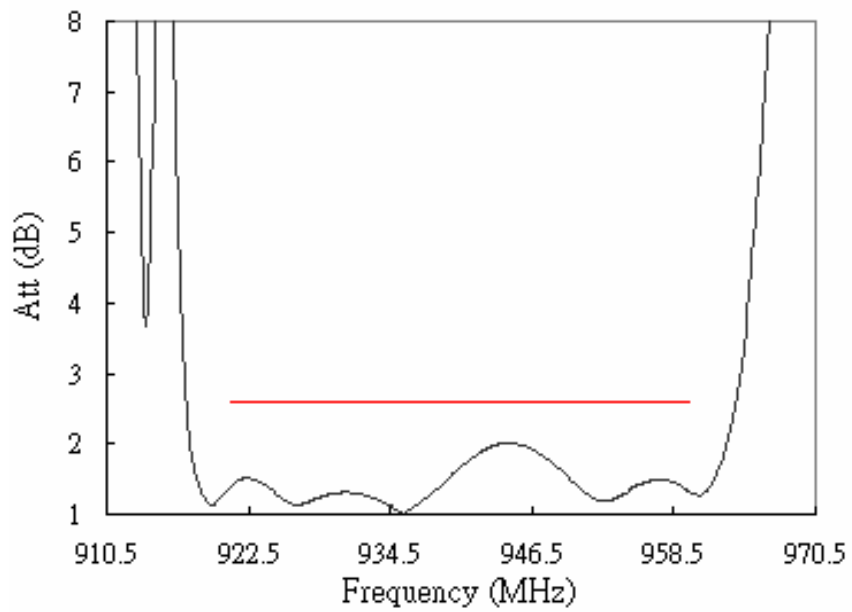

**D. MEASUREMENT CIRCUIT:**

HP Network analyzer

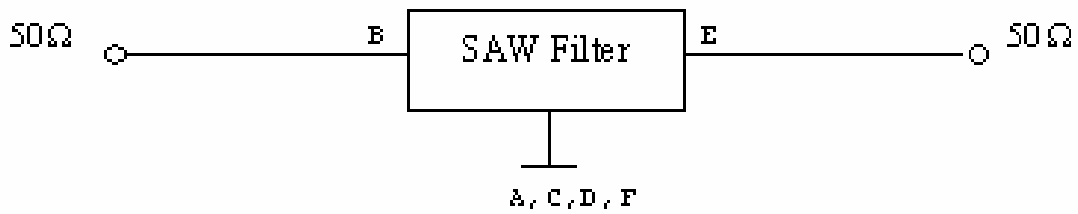

**E.OUTLINE DRAWING:**

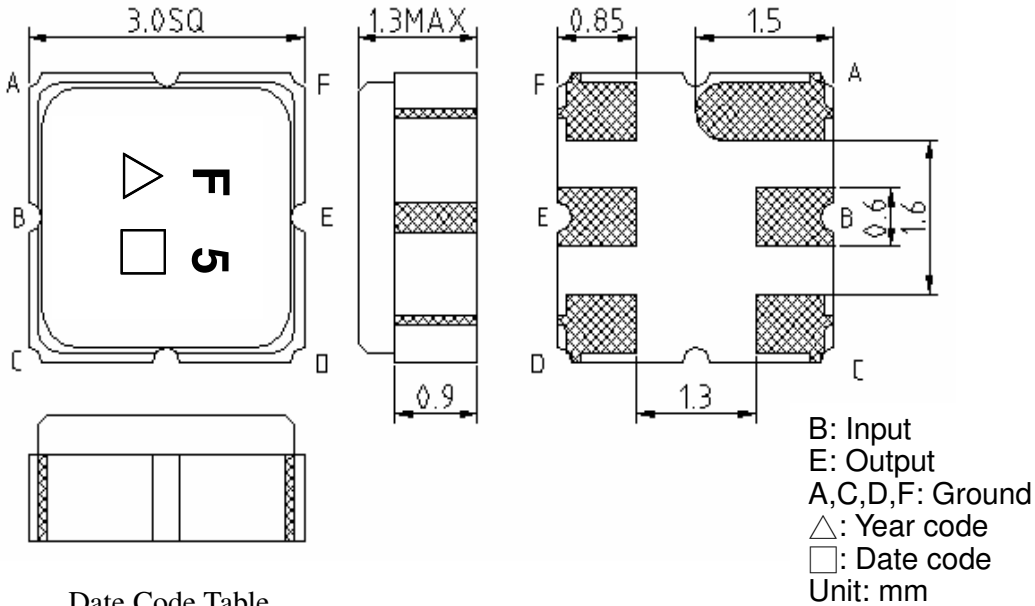

Date Code Table

WK01	WK02	WK03	WK04	WK05	WK06	WK07	WK08	WK09	WK10	WK11	WK12	WK13
A	B	C	D	E	F	G	H	I	J	K	L	M
WK14	WK15	WK16	WK17	WK18	WK19	WK20	WK21	WK22	WK23	WK24	WK25	WK26
N	O	P	Q	R	S	T	U	V	W	X	Y	Z
WK27	WK28	WK29	WK30	WK31	WK32	WK33	WK34	WK35	WK36	WK37	WK38	WK39
a	b	c	d	e	f	g	h	i	j	k	l	m
WK40	WK41	WK42	WK43	WK44	WK45	WK46	WK47	WK48	WK49	WK50	WK51	WK52
n	o	p	q	r	s	t	u	v	w	x	y	z

**F.PCB FOOTPRINT:**

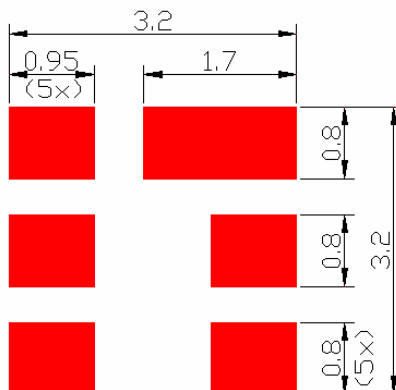

**G. PACKING:**

**1. REEL DIMENSION**

(Please refer to FR-75D10 for packing quantity )

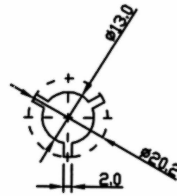
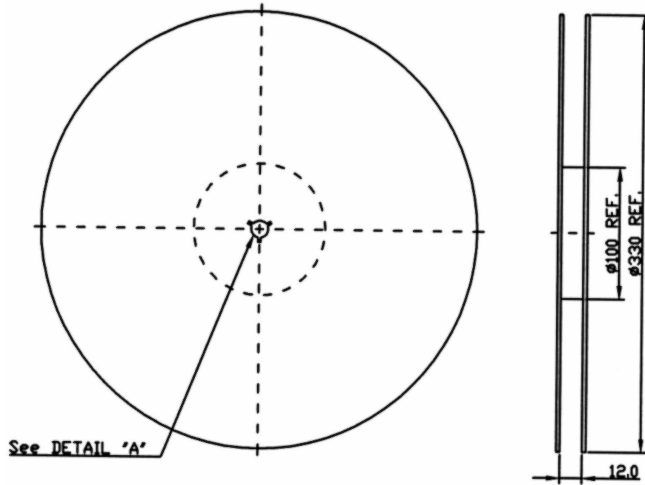

**2. TAPE DIMENSION**

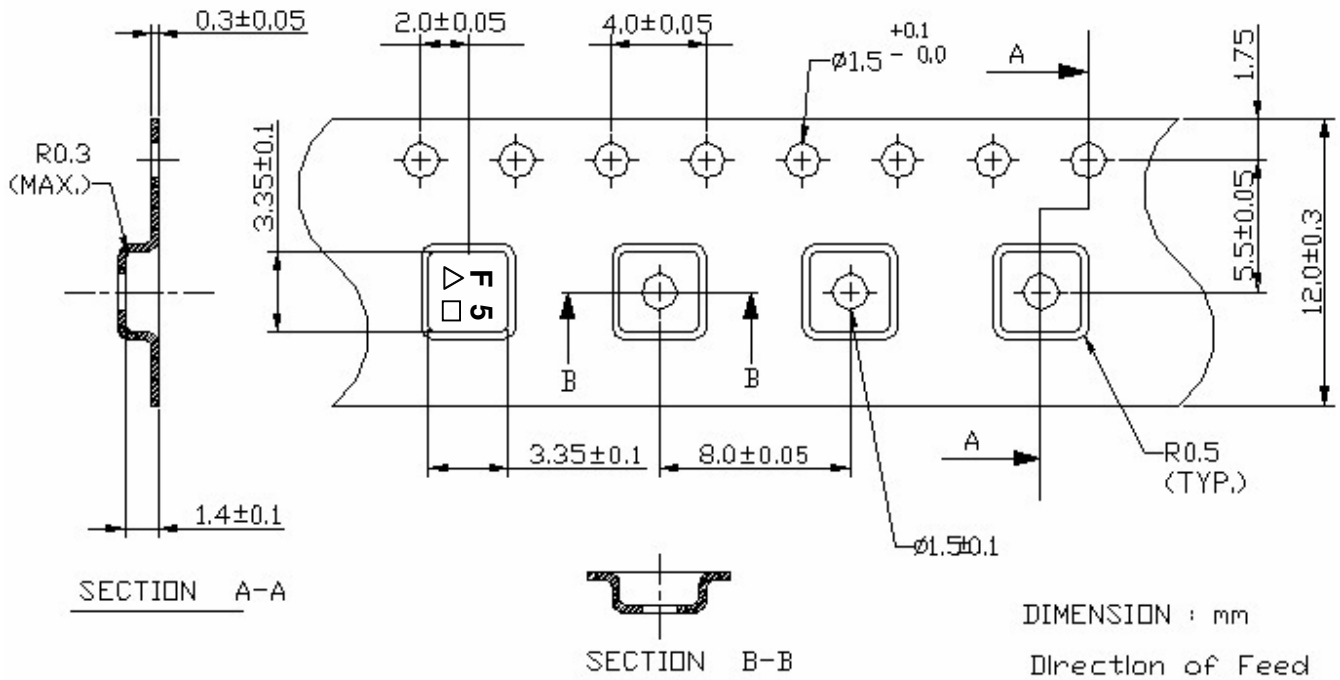

DIMENSION : mm

Direction of Feed

### H. Recommended Reflow Profile:

1. Preheating shall be fixed at 150~180°C for 60~90 seconds.
2. Ascending time to preheating temperature 150°C shall be 30 seconds min.
3. Heating shall be fixed at 220°C for 50~80 seconds and at 260°C+0/-5°C peak (20~40sec).
4. Time: 2 times.

