



TAI-SAW TECHNOLOGY CO., LTD.

No. 3, Industrial 2nd Rd., Ping-Chen Industrial District,
Taoyuan, 324, Taiwan, R.O.C.

TEL: 886-3-4690038 FAX: 886-3-4697532

E-mail: tstsales@mail.taisaw.com Web: www.taisaw.com

Product Specifications Approval Sheet

Product Description: SAW Filter 221.6 MHz 10MHz Bw SMD 5.0x5.0 mm

TST Part No.: TA0576B

Customer Part No.: _____

Customer signature required
Company: _____
Division: _____
Approved by : _____
Date: _____

Checked by: _____ Anne Chen 

Approved by: _____ Bob Chau 

Date: _____ 01, 14, 2015

1. Customer signed back is required before TST can proceed with sample build and receive orders.
2. Orders received without customer signed back will be regarded as agreement on the specifications.
3. Any specifications changes must be approved upon by both parties and a new revision of specifications shall be released to reflect the changes.



TAI-SAW TECHNOLOGY CO., LTD.

No. 3, Industrial 2nd Rd., Ping-Chen Industrial District,
Taoyuan, 324, Taiwan, R.O.C.

TEL: 886-3-4690038 FAX: 886-3-4697532

E-mail: tstsales@mail.taisaw.com Web: www.taisaw.com

SAW Filter 221.6 MHz

MODEL NO.: TA0576B

REV. NO.: 1

A. MAXIMUM RATING:

1. Input Power Level: 20 dB_m
2. DC voltage: 5 V
3. Operating Temperature: -40°C to +85°C
4. Storage Temperature: -40°C to +85°C

RoHS Compliant
Lead free
Lead-free soldering

Electrostatic Sensitive Device (ESD)

B. ELECTRICAL CHARACTERISTICS:

Item	Unit	Min.	Typical	Max.
Center frequency F_c	MHz	-	221.6	-
Minimum Insertion Loss IL_{min} (reference level)	dB	-	1.95	3.0
Amplitude ripple 218.1~225.1 MHz	dB	-	1.1	2.2
3dB Bandwidth BW_{-3dB}	MHz	7	10	-
Attenuation (Reference level from IL_{min})				
10 ~ $F_c - 35$ MHz	dB	38	43	-
$F_c + 35$ ~ 500 MHz	dB	38	50	-
Source impedance Z_s	Ω	-	50	-
Load impedance Z_L	Ω	-	50	-

Note: IL_{min} is the minimum of the pass band attenuation. The center frequency F_c is the mean value of the upper and lower frequencies at the 3dB filter attenuation level relative to the IL_{min} .

C. MEASUREMENT CIRCUIT:

HP Network analyzer

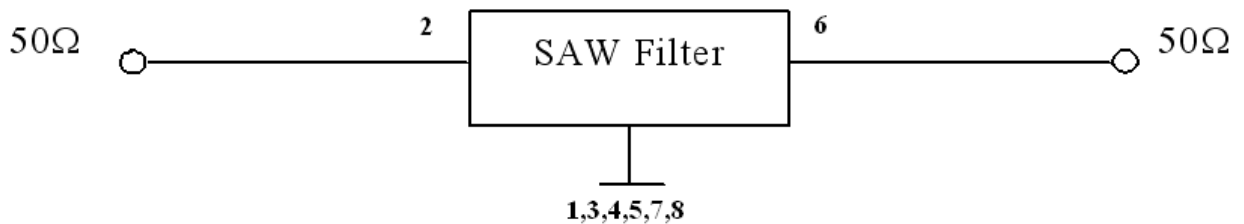

D. Frequency Characteristics :

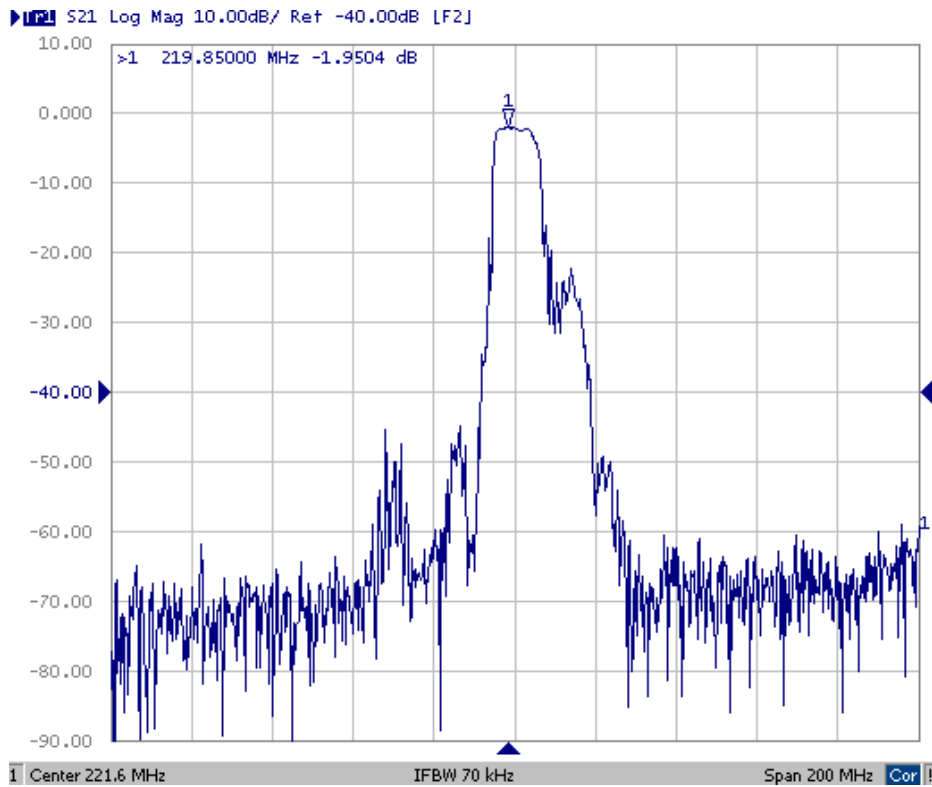
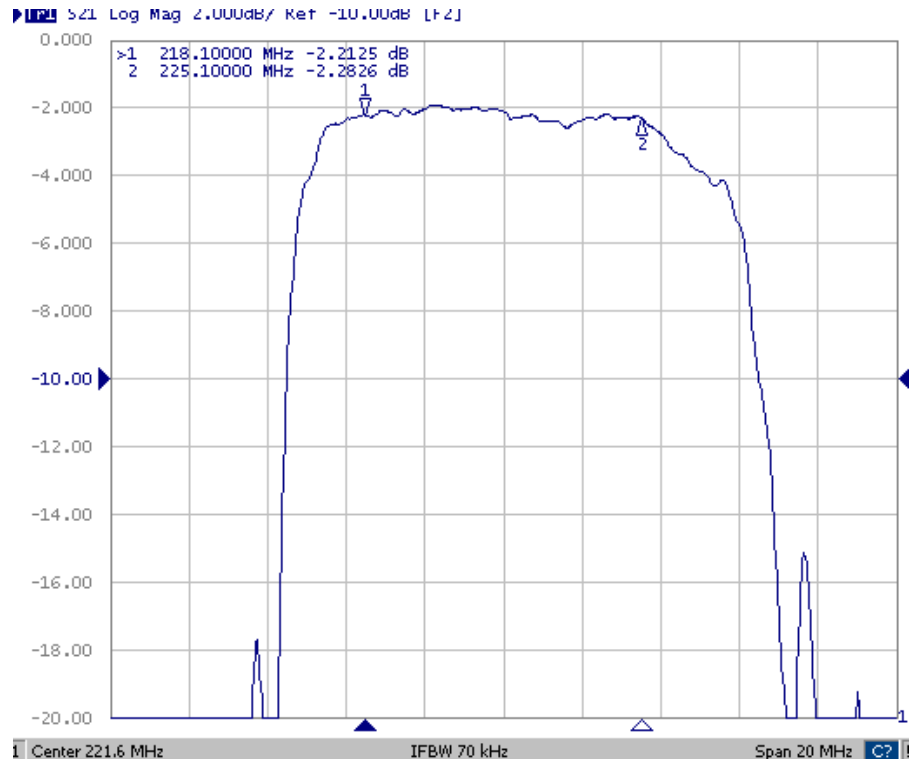

E.OUTLINE DRAWING:

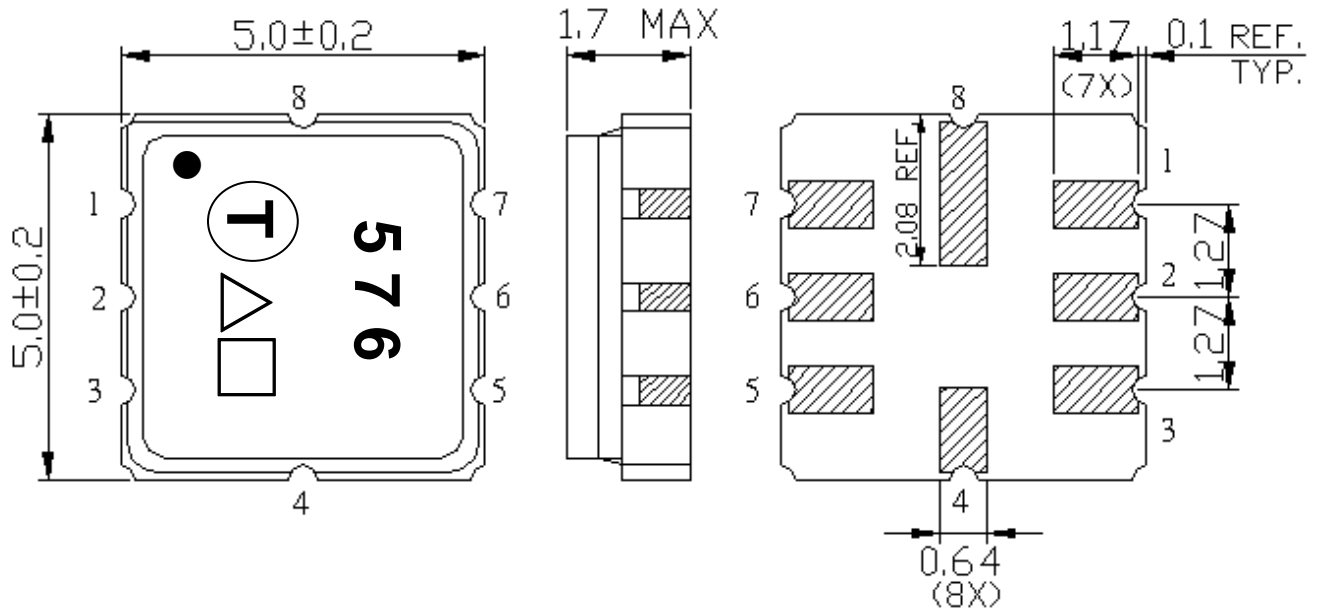

- Date code: Provided by planer each year
- △ Product Year Code

Year	2013 2017	2014 2018	2015 2019	2016 2020
Product Code	A	a	<u>A</u>	<u>a</u>

- #2 : Input
- #6 : Output
- #4 . 8 : Case Ground
- #1.3.5.7 : Ground
- Unit : mm

F.PCB FOOTPRINT:

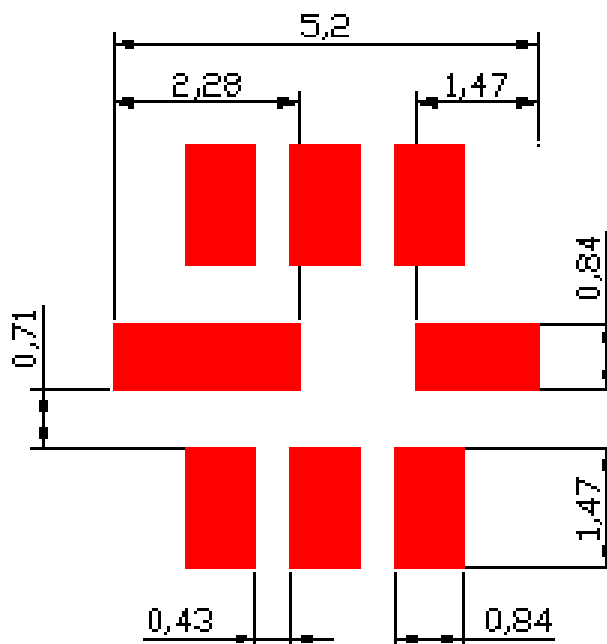

G. PACKING:

1. REEL DIMENSION

(Please refer to FR-75D10 for packing quantity)

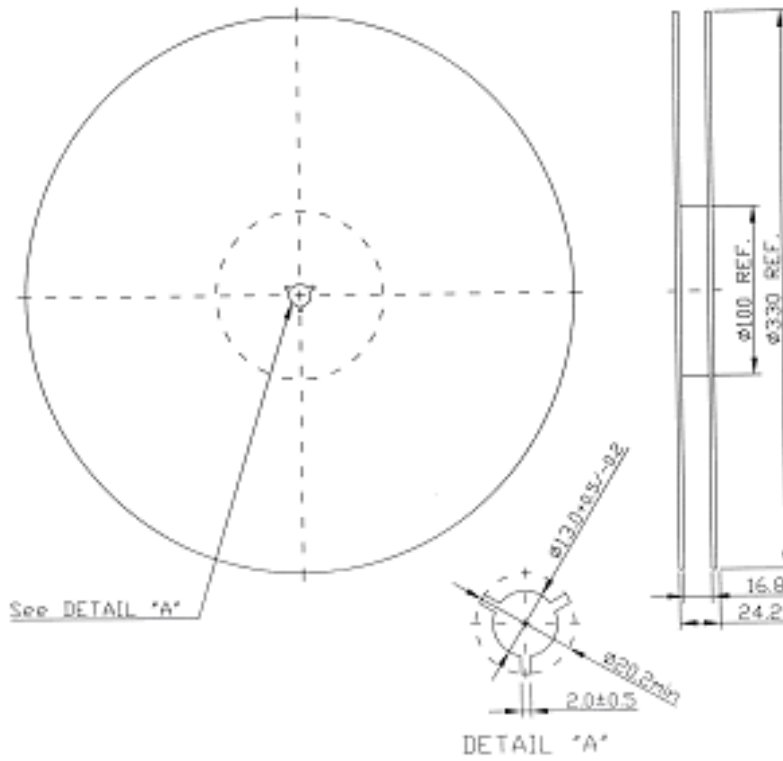

2. TAPE DIMENSION

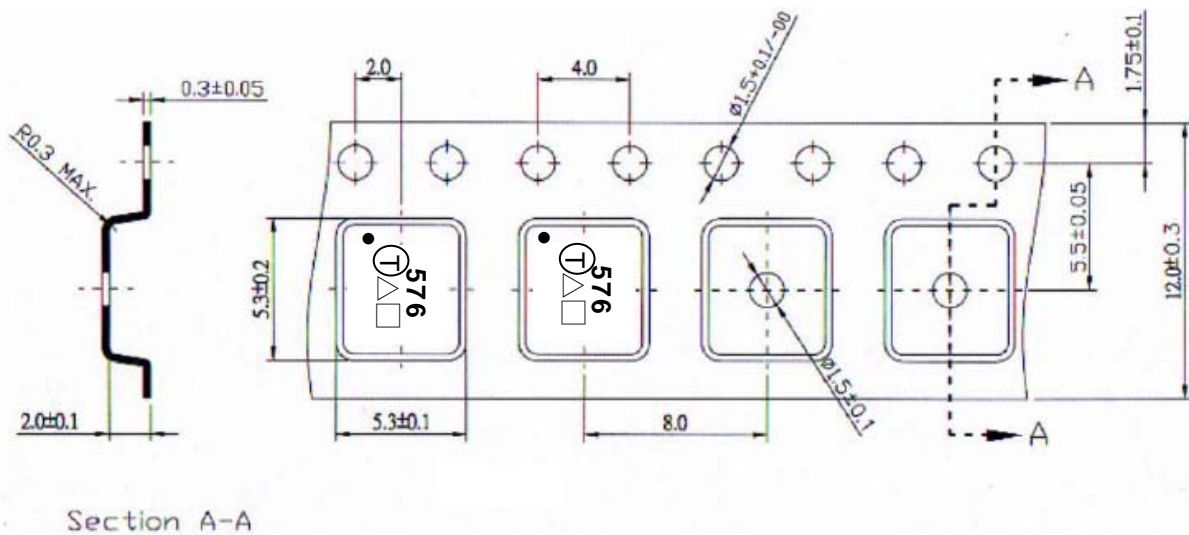

Direction of Feed
→

H.RECOMMENDED REFLOW PROFILE:

1. Preheating shall be fixed at 150~180°C for 60~90 seconds.
2. Ascending time to preheating temperature 150°C shall be 30 seconds min.
3. Heating shall be fixed at 220°C for 50~80 seconds and at 245~260°C peak (min. 10sec).
4. Time : 2 times.

