



# TAI-SAW TECHNOLOGY CO., LTD.

No. 3, Industrial 2nd Rd., Ping-Chen Industrial District,  
Taoyuan, 324, Taiwan, R.O.C.

TEL: 886-3-4690038 FAX: 886-3-4697532

E-mail: [tstsales@mail.taisaw.com](mailto:tstsales@mail.taisaw.com) Web: [www.taisaw.com](http://www.taisaw.com)

## Product Specification Approval Sheet

Product Name: SAW Filter 159.0125MHz 6.025MHz BW SMD 7.0x5.0 mm

TST Parts No.:TA0942B

Customer Parts No.:\_\_\_\_\_

Customer signature required
Company: _____
Division: _____
Approved by : _____
Date: _____

Checked by: \_\_\_\_\_ Anne Chen 

Approved by: \_\_\_\_\_ Bob Chau 

Date: \_\_\_\_\_ 03, 20, 2015

1. Customer signed back is required before TST can proceed with sample build and receive orders.
2. Orders received without customer signed back will be regarded as agreement on the specifications.
3. Any specifications changes must be approved upon by both parties and a new revision of specifications shall be released to reflect the changes.



# TAI-SAW TECHNOLOGY CO., LTD.

No. 3, Industrial 2nd Rd., Ping-Chen Industrial District,  
Taoyuan, 324, Taiwan, R.O.C.

TEL: 886-3-4690038 FAX: 886-3-4697532

E-mail: [tstsales@mail.taisaw.com](mailto:tstsales@mail.taisaw.com) Web: [www.taisaw.com](http://www.taisaw.com)

## SAW Filter 159.0125 MHz

MODEL NO.: TA0942B

REV. NO.:1

### A. MAXIMUM RATING:

1. Input Power Level: 20 dB<sub>m</sub>
2. DC voltage: 5 V
3. Operating Temperature: -40°C to +85°C
4. Storage Temperature: -40°C to +85°C

RoHS Compliant  
Lead free  
Lead-free soldering

**Electrostatic Sensitive Device (ESD)**

### B. ELECTRICAL CHARACTERISTICS:

Item		Specification			
		Unit	Min.	Typ.	Max.
Center Frequency	F <sub>c</sub>	MHz	-	159.0125	-
Insertion Loss	IL <sub>min</sub> (reference level)	dB	-	1.85	2.8
Bandwidth	BW <sub>-3dB</sub>	MHz	6.025	8.2	-
Absolute Attenuation(reference to IL <sub>min</sub> dB)					
F <sub>c</sub> -50 ~ F <sub>c</sub> -30	MHz	dB	42	57	-
F <sub>c</sub> -30 ~ F <sub>c</sub> -15	MHz	dB	36	43	-
F <sub>c</sub> +30 ~ F <sub>c</sub> +50	MHz	dB	42	57	-
Source impedance	Z <sub>s</sub>	Ω	-	50	-
Load impedance	Z <sub>L</sub>	Ω	-	50	-

Note: IL<sub>min</sub> is the minimum of the pass band attenuation. The center frequency F<sub>c</sub> is the mean value of the upper and lower frequencies at the 3dB filter attenuation level relative to the IL<sub>min</sub>.

### MEASUREMENT CIRCUIT:

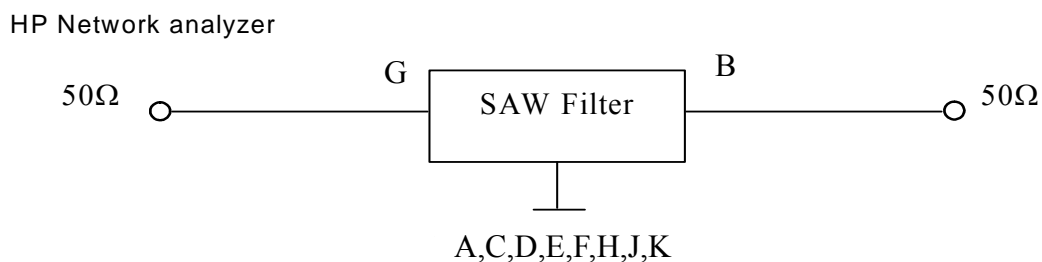

### C. Frequency Characteristics :

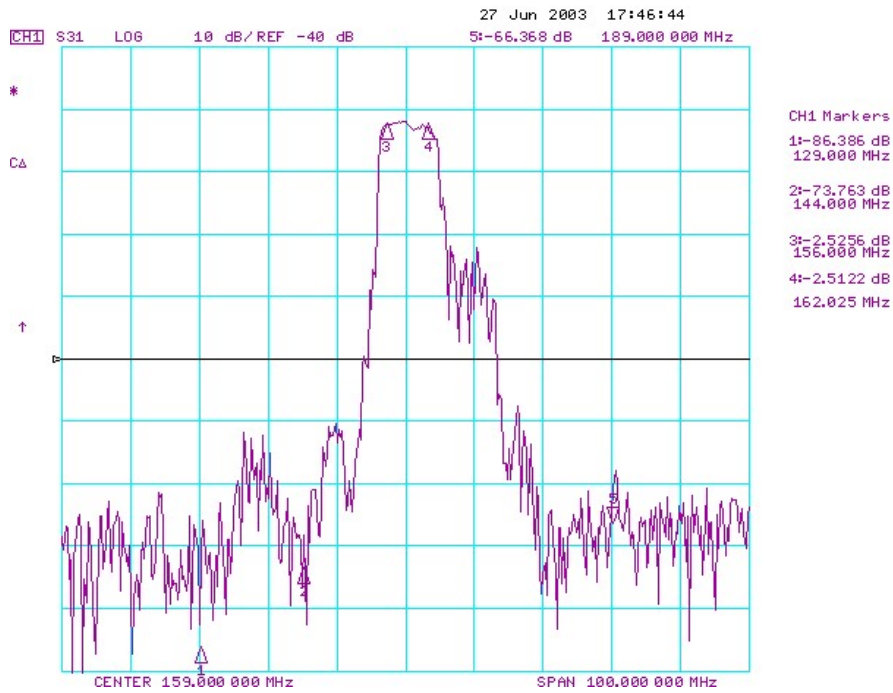

**D. OUTLINE DRAWING:**

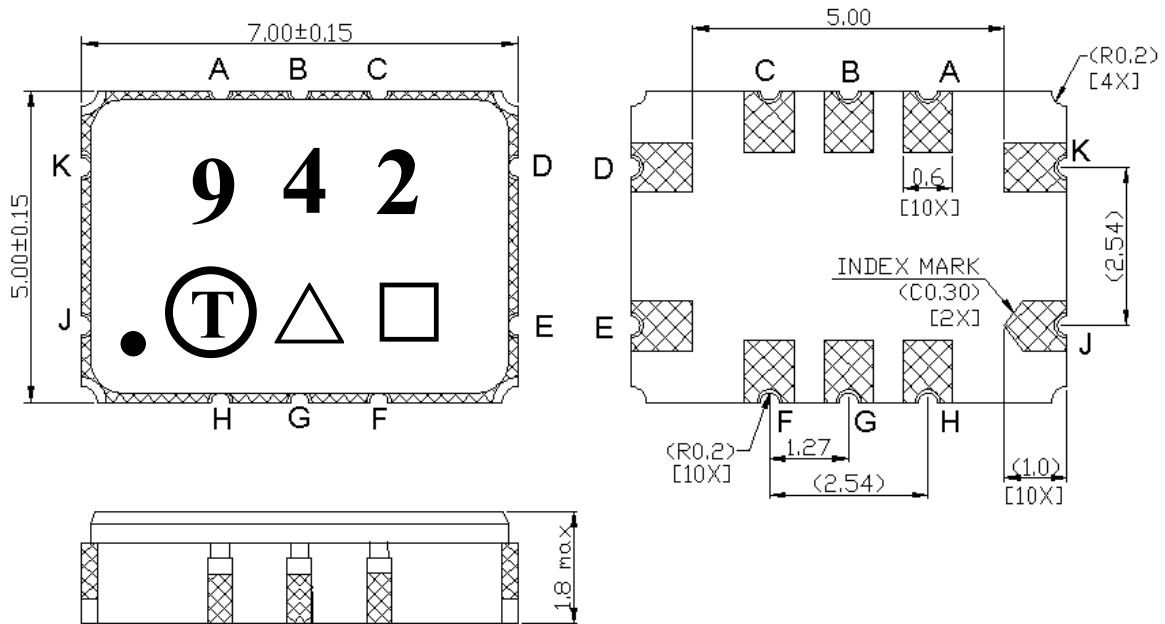

**Pin configuration**

#G : Input

#B : Output Unit : mm

#A,C,D,E,F,H,J,K : grounded

△ =Year Code

□ =Date Code

**Product Year Code**

Year	2013	2014	2015	2016
	2017	2018	2018	2020
Product Code	A	a	△	□

**F. PCB Footprint :**

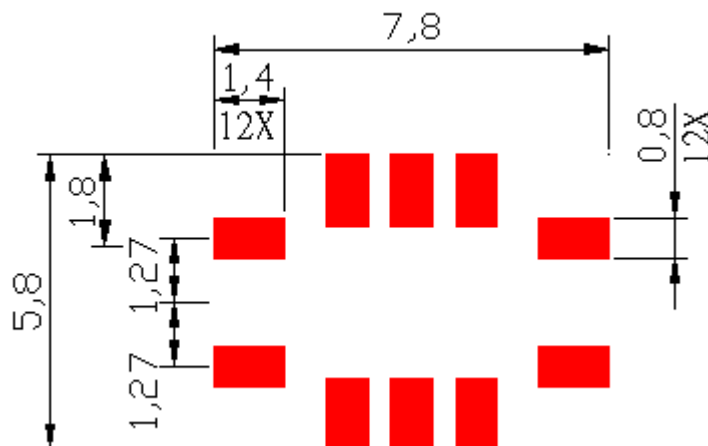

**G. PACKING:**

**1. REEL DIMENSION**

(Please refer to FR-75D10 for packing quantity )

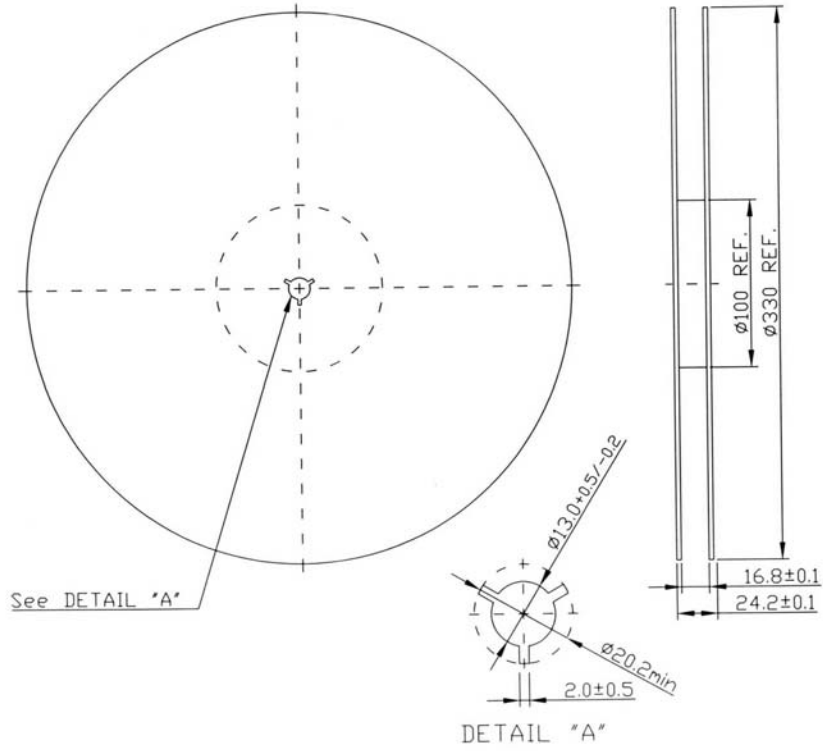

**2. TAPE DIMENSION**

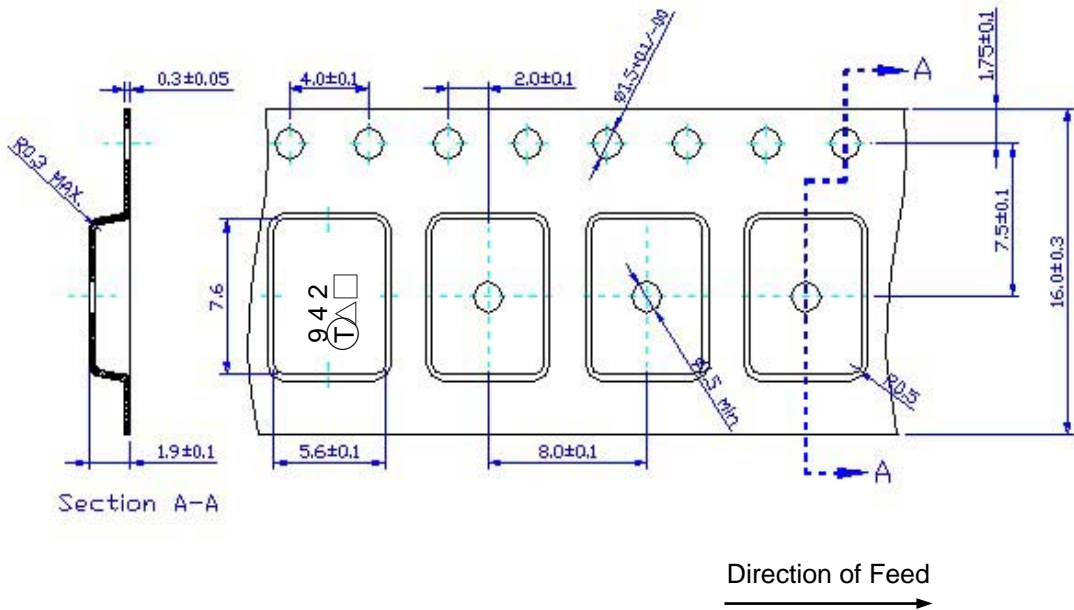

## H. RECOMMENDED REFLOW PROFILE :

1. Preheating shall be fixed at 150~180°C for 60~90 seconds.
2. Ascending time to preheating temperature 150°C shall be 30 seconds min.
3. Heating shall be fixed at 220°C for 50~80 seconds and at 245~260°C peak (min. 10sec).
4. Time : 2 times.

