



TAI-SAW TECHNOLOGY CO., LTD.

No. 3, Industrial 2nd Rd., Ping-Chen Industrial District,
Taoyuan, 324, Taiwan, R.O.C.

TEL: 886-3-4690038 FAX: 886-3-4697532

E-mail: tstsales@mail.taisaw.com Web: www.taisaw.com

Product Specifications Approval Sheet

Product Name: SAW Filter 169MHz SMD 5.0×5.0 mm

TST Parts No.:TA0437A

Customer Parts No.:_____

Company:_____
Division:_____
Approved by :_____
Date:_____

Checked by:_____ Anne Chen *Anne Chen*

Approval by:_____ Andy Yu *Andy Yu*

Date:_____ 2019/4/22

1. Customer signed back is required before TST can proceed with sample build and receive orders.
2. Orders received without customer signed back will be regarded as agreement on the specifications.
3. Any specifications changes must be approved upon by both parties and a new revision of specifications shall be released to reflect the changes.



TAI-SAW TECHNOLOGY CO., LTD.

No. 3, Industrial 2nd Rd., Ping-Chen Industrial District,
Taoyuan, 324, Taiwan, R.O.C.

TEL: 886-3-4690038 FAX: 886-3-4697532

E-mail: tstsales@mail.taisaw.com Web: www.taisaw.com

SAW Filter 169 MHz

MODEL NO.: TA0437A

REV. NO.:2.0

A. MAXIMUM RATING:

1. Input Power Level: 15 dB_m
2. DC voltage: 3 V
3. Operating Temperature: -10°C to +70°C
4. Storage Temperature: -40°C to +85°C
5. Moisture Sensitive Level (MSL): Level 1

RoHS Compliant
Lead free
Lead-free soldering

B. ELECTRICAL CHARACTERISTICS:

Item		Unit	Specification			
			Min.	Typ.	Max.	
Center Frequency	F _c	MHz	-	169	-	
Insertion Loss	IL _{min} (reference level)	dB	-	1.5	2.8	
Bandwidth	BW _{-3dB}	MHz	6	8.8	-	
Absolute Attenuation (reference to IL _{min} dB)						
F _c -50 ~ F _c -30		MHz	dB	42	54	-
F _c -30 ~ F _c -15		MHz	dB	36	52	-
F _c +30 ~ F _c +50		MHz	dB	40	51	-
Source impedance	Z _s	Ω	-	50	-	
Load impedance	Z _L	Ω	-	50	-	

Note: IL_{min} is the minimum of the pass band attenuation. The center frequency F_c is the mean value of the upper and lower frequencies at the 3dB filter attenuation level relative to the IL_{min}.

C. Frequency Characteristics:

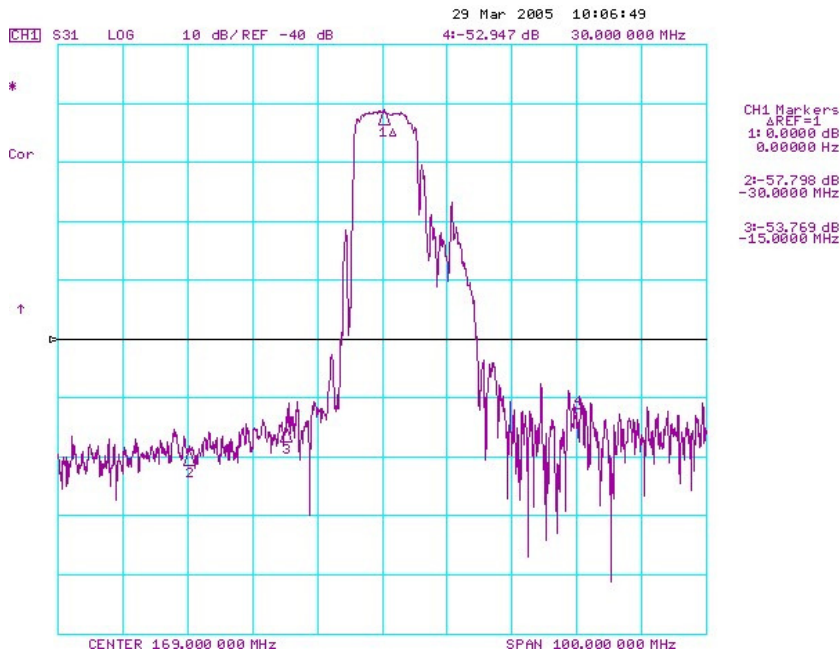
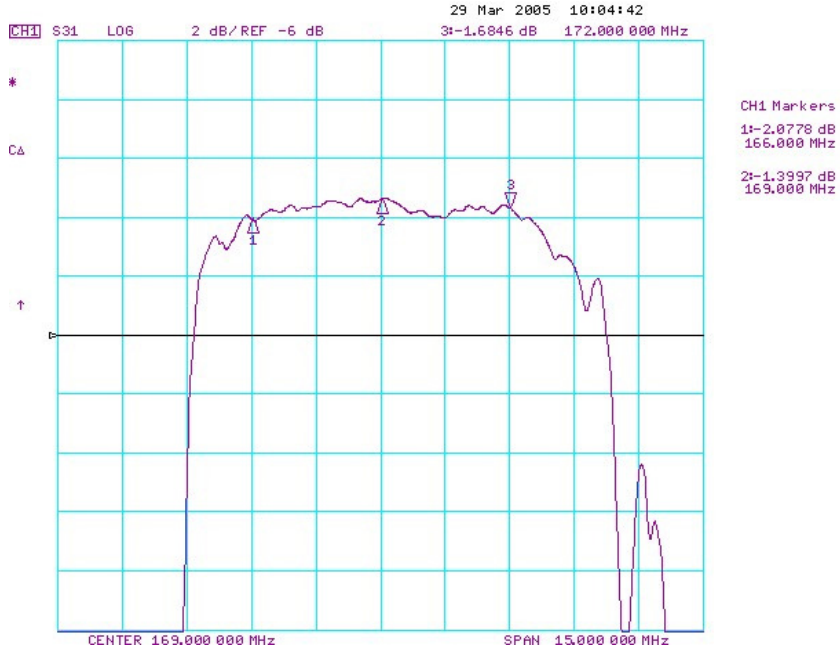

D. MEASUREMENT CIRCUIT:

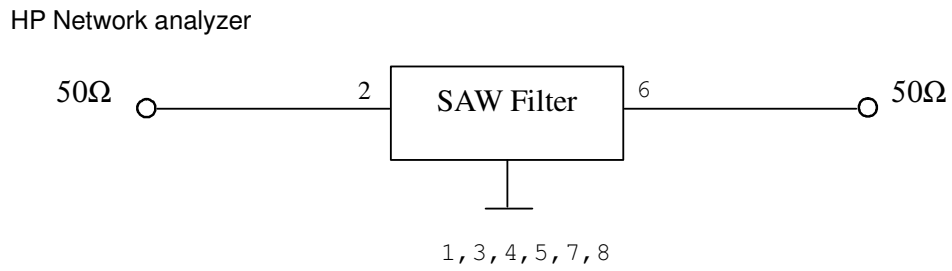

E. OUTLINE DRAWING:

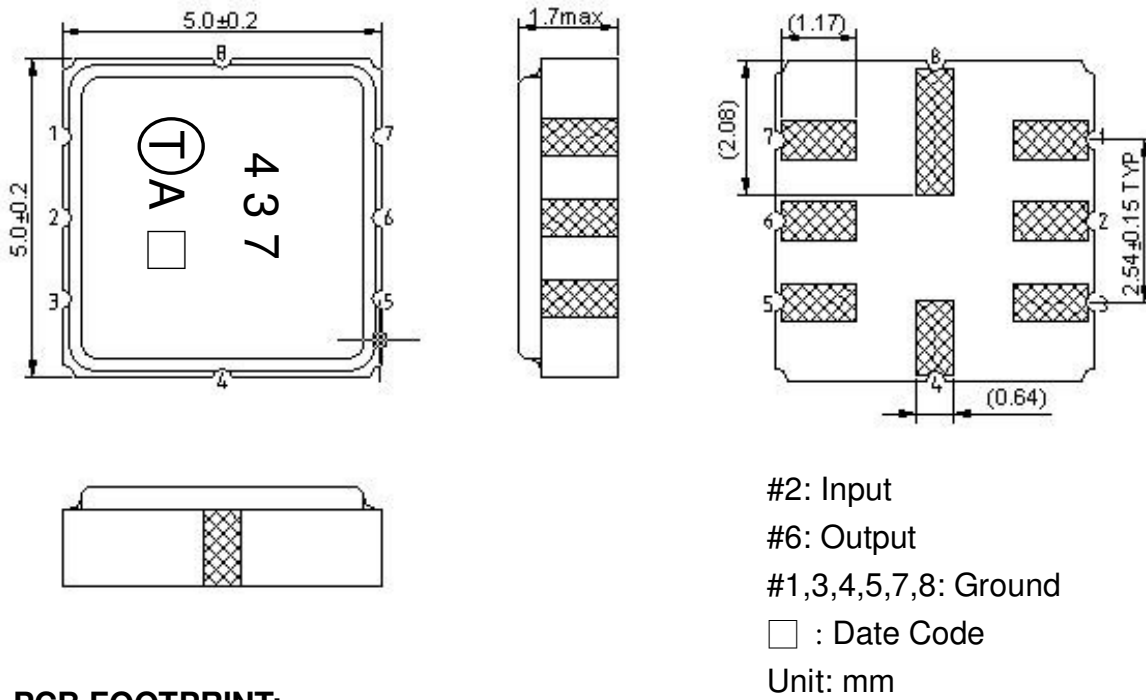

F. PCB FOOTPRINT:

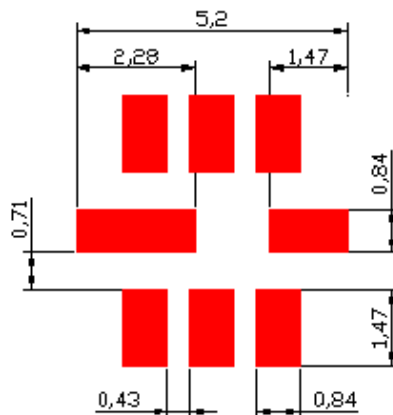

G. PACKING:

1. REEL DIMENSION

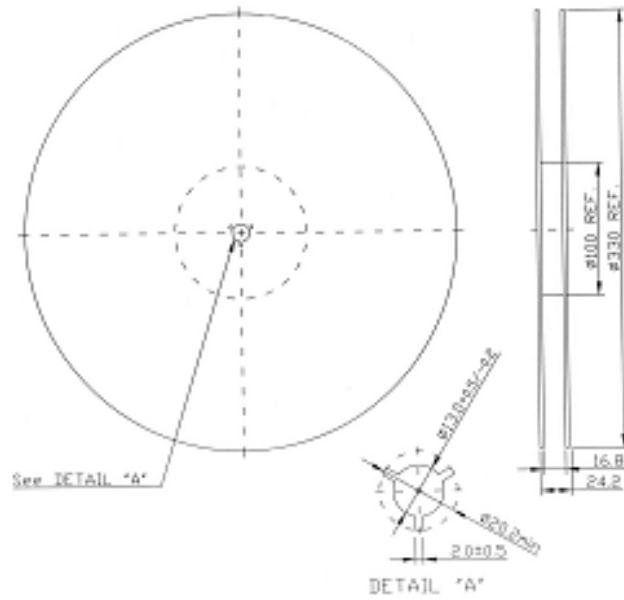

2. TAPE DIMENSION

