



# TAI-SAW TECHNOLOGY CO., LTD.

No. 3, Industrial 2nd Rd., Ping-Chen Industrial District,  
Taoyuan, 324, Taiwan, R.O.C.

TEL: 886-3-4690038 FAX: 886-3-4697532

E-mail: [tstsales@mail.taisaw.com](mailto:tstsales@mail.taisaw.com) Web: [www.taisaw.com](http://www.taisaw.com)

## Product Specifications Approval Sheet

Product Description: DR Filter 5240MHz (BW=200MHz) 3.25x1.85x2.58

TST Parts No.: TR0008A

Customer Parts No.: \_\_\_\_\_

Company: _____
Division: _____
Approved by : _____
Date: _____

Checked by: \_\_\_\_\_ Hong Pu Lin *Hong Pu Lin*

Approval by: \_\_\_\_\_ Andy Yu *Andy Yu*

Date: \_\_\_\_\_ 5 / 9 / 2018

1. Customer signed back is required before TST can proceed with sample build and receive orders.
2. Orders received without customer signed back will be regarded as agreement on the specifications.
3. Any specifications changes must be approved upon by both parties and a new revision of specifications shall be released to reflect the changes.



# TAI-SAW TECHNOLOGY CO., LTD.

No.3, Industrial 2nd Rd., Ping-Chen Industrial District, Taoyuan, Taiwan, R.O.C.

TEL: 886-3-4690038 FAX: 886-3-4697532

E-mail: [tstsales3@mail.taisaw.com](mailto:tstsales3@mail.taisaw.com) Web: [www.taisaw.com](http://www.taisaw.com)

DR Filter 5240MHz 200MHz BW

MODEL NO.: TR0008A

REV. NO.1

## A. MAXIMUM RATING:

1. Operating temperature range: -40°C to 85°C
2. Storage temperature range: -40°C to 85°C
3. Input Power Level : 1W
4. Input/Output Impedance:50 Ohm
5. Moisture Sensitive Level: Level 1 (MSL1)

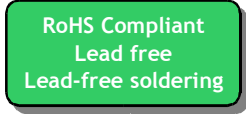

**Electrostatic Sensitive Device**

## B. CHARACTERISTICS:

Item	Unit	Spec.
Center frequency, <b>F<sub>c</sub></b>	MHz	5240
Insertion Loss, (5140~5340MHz) 25°C	dB	1.5max
Insertion Loss, (5140~5340MHz)(0°C ~70°C)	dB	2.1max
Passband Ripple (5140~5340MHz)	dB	1.5max
Return Loss (5140~5340MHz)	dB	10min
Band Width(5140~5340MHz)	MHz	200min
Specifies the absolute value of Attenuation		
2400~2700MHz	dB	25min
5480~5860MHz (25°C)	dB	19min
5480~5860MHz (0°C~70°C)	dB	17min

### C. FREQUENCY CHARACTERISTICS:

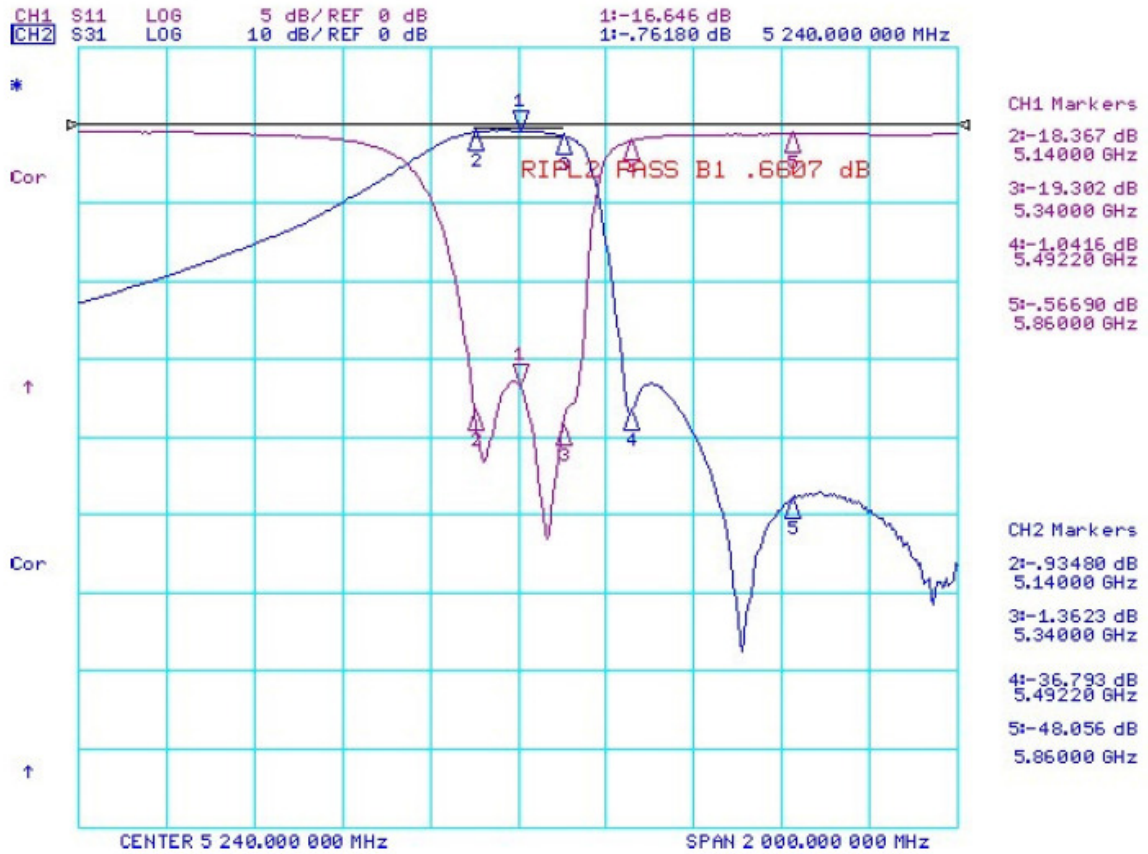

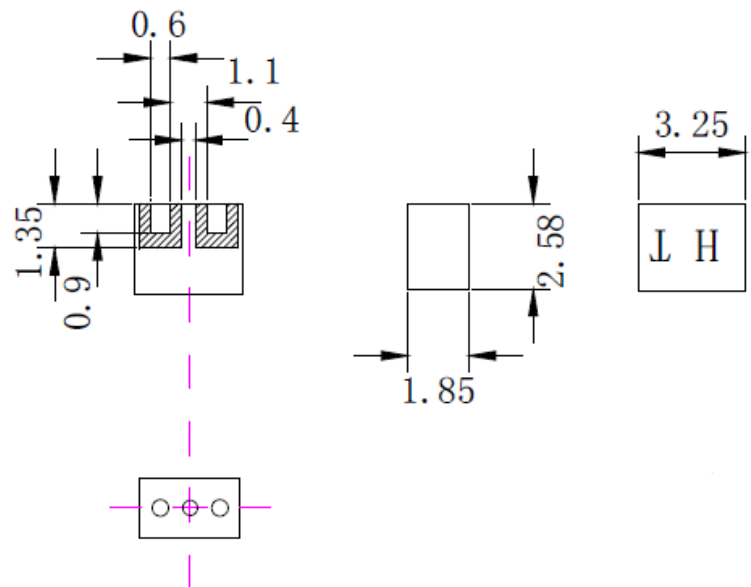

### D. OUTLINE DRAWING:

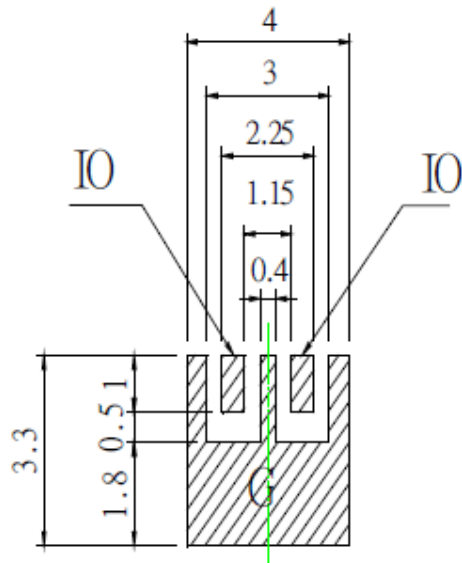

Dimensions in mm  
 Tolerance: ±0.2

**E. FOOT PRINTING:**



 Solder pads:

I/O Pads must be connected to lines with 50Ω impedance. In the application a termination of 50Ω must be realized.

**F. PACKING:**

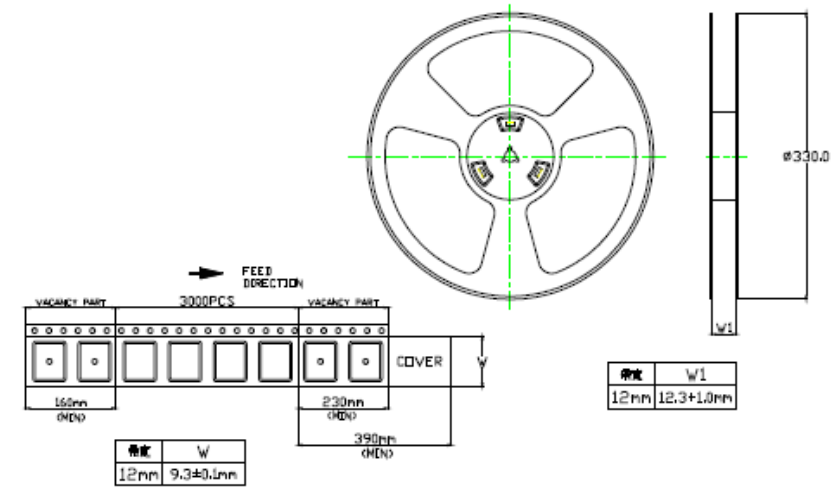
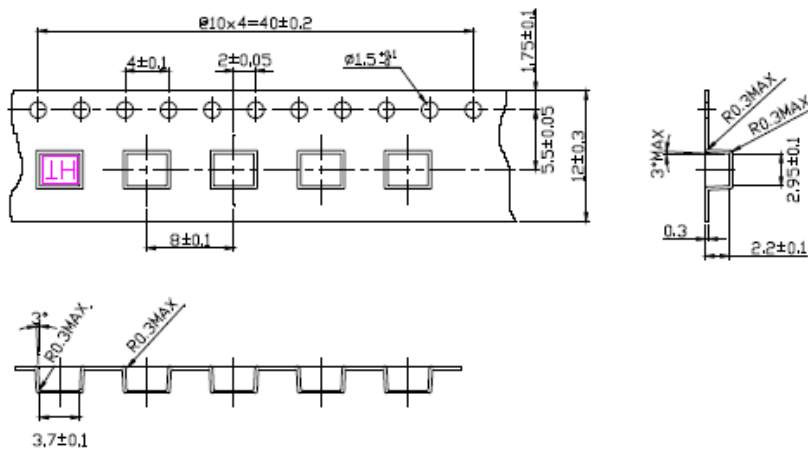

1.Outer Carton

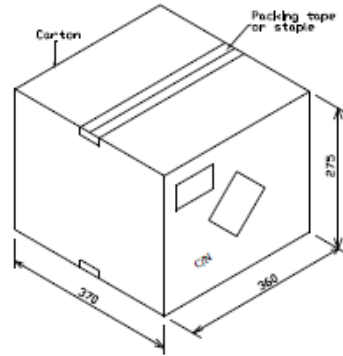

2.Inner Carton

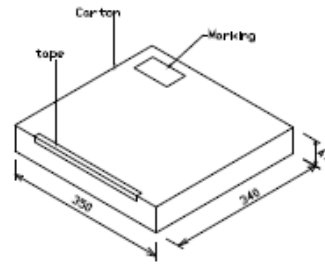

3.Bag

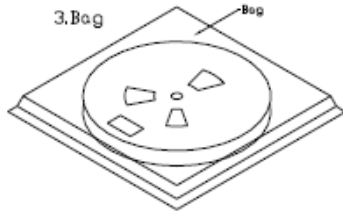

4.Taping

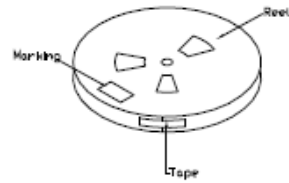

Unit:mm

**G. RECOMMENDED REFLOW PROFILE:**

