



TAI-SAW TECHNOLOGY CO., LTD.

No. 3, Industrial 2nd Rd., Ping-Chen Industrial District,
Taoyuan, 324, Taiwan, R.O.C.

TEL: 886-3-4690038 FAX: 886-3-4697532

E-mail: tstsales@mail.taisaw.com Web: www.taisaw.com

Product Specifications Approval Sheet

Product Description: Dielectric Filter 3250MHz BW 300MHz Size 7.40x4.62mm
TST Parts No.: TR0133AA0090

Customer Parts No.: _____

Customer signature required
Company: _____
Division: _____
Approved by : _____
Date: _____

Checked by: _____ Nina Chen *Nina Chen*

Approved by: _____ Kazuma Lee *Kazuma Lee*

Date: _____ 2023/07/07

1. Customer signed back is required before TST can proceed with sample build and receive orders.
2. Orders received without customer signed back will be regarded as agreement on the specifications.
3. Any specifications changes must be approved upon by both parties and a new revision of specifications shall be released to reflect the changes.



TAI-SAW TECHNOLOGY CO., LTD.

No. 3, Industrial 2nd Rd., Ping-Chen Industrial District,
Taoyuan, 324, Taiwan, R.O.C.

TEL: 886-3-4690038 FAX: 886-3-4697532

E-mail: ttsales@mail.taisaw.com Web: www.taisaw.com

Dielectric Filter 3250MHz BW 300MHz Size 7.40x4.62mm

MODEL NO.: TR0133AA0090

REV. NO.:1.0

A. Maximum Rating:

1. Input Power:1W
2. Operating Temperature: -40°C to +85°C
3. Storage Temperature: 0°C to +40°C
4. Moisture Sensivity Level: 2a(MSL 2a)

RoHS Compliant
Lead free
Lead-free soldering

Electrostatic Sensitive Device (ESD)

B. Electrical Characteristics:

ITEM		SPECIFICATION		
		Min	Typ	Max
INSERTION LOSS	3100~3400 MHz		1.0 dB	2.0 dB
RIPPLE	3100~3400 MHz		0.5 dB	1.0 dB
RETURN LOSS	3125~3375 MHz	10 dB	13 dB	
ATTENUATION	at 2000~2500 MHz	35 dB	40 dB	
	at 4000~5000 MHz	25 dB	32 dB	

ATTENUATION specifies the absolute value of attenuation.

C. Frequency Characteristics:

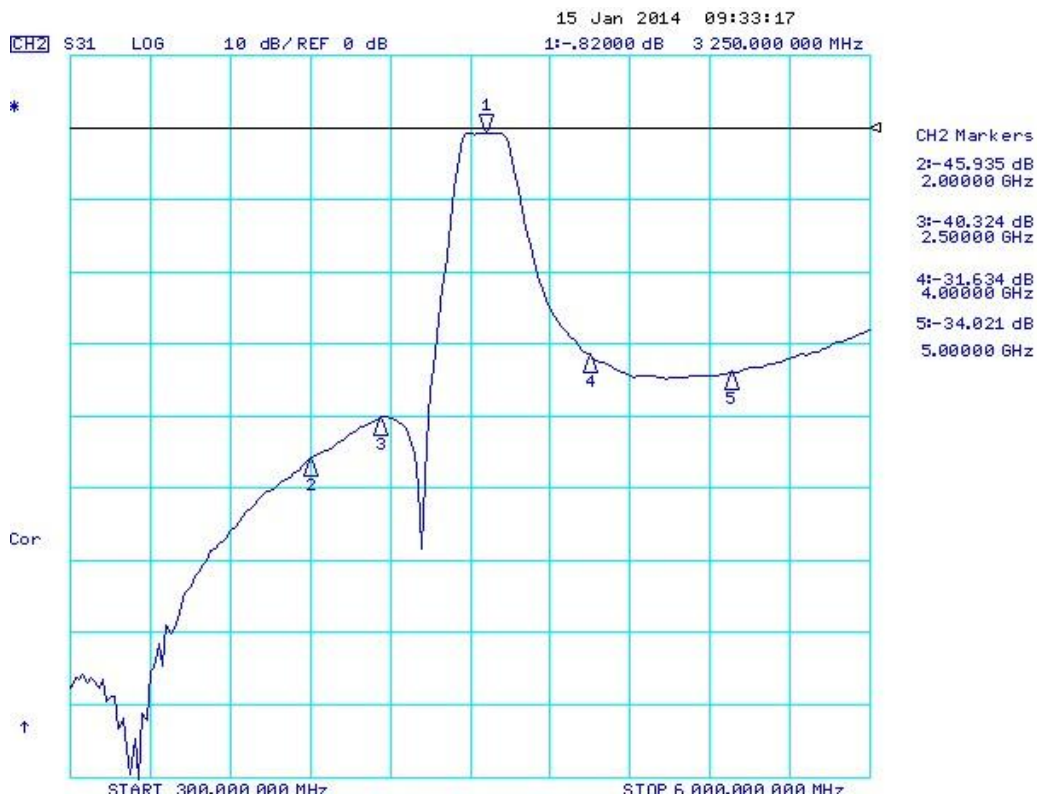
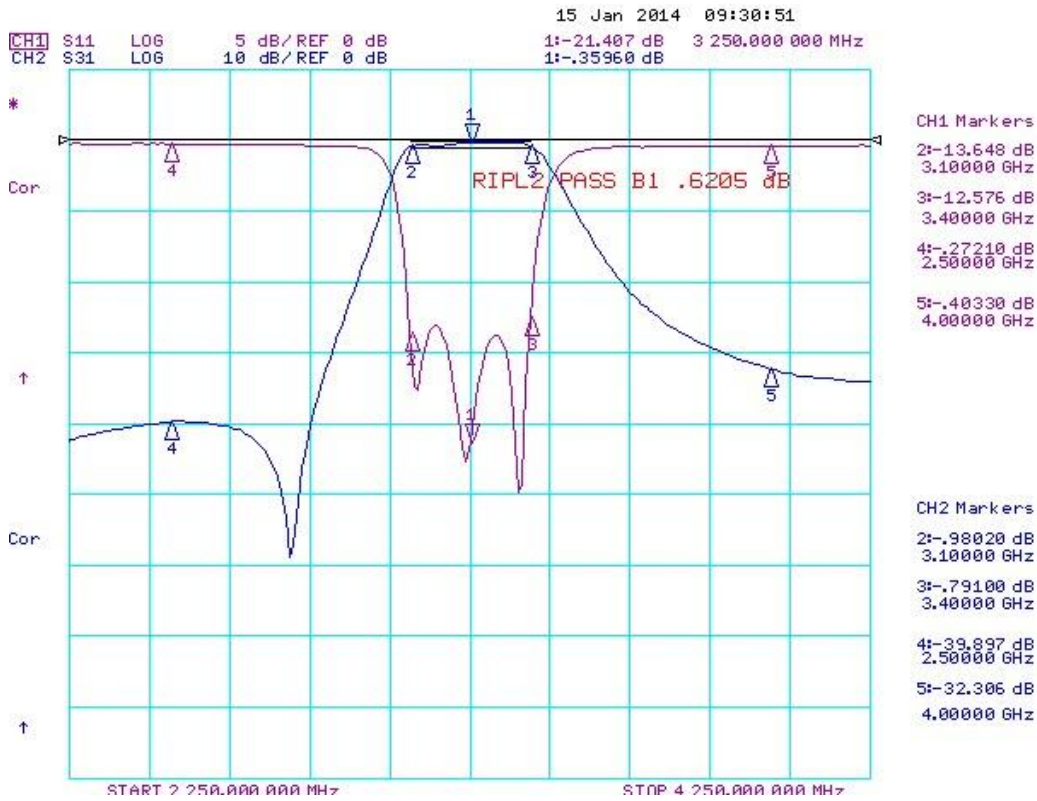

D. Dimension:

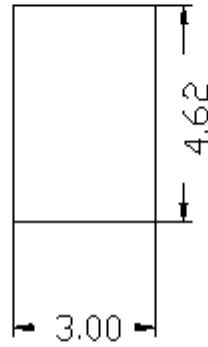
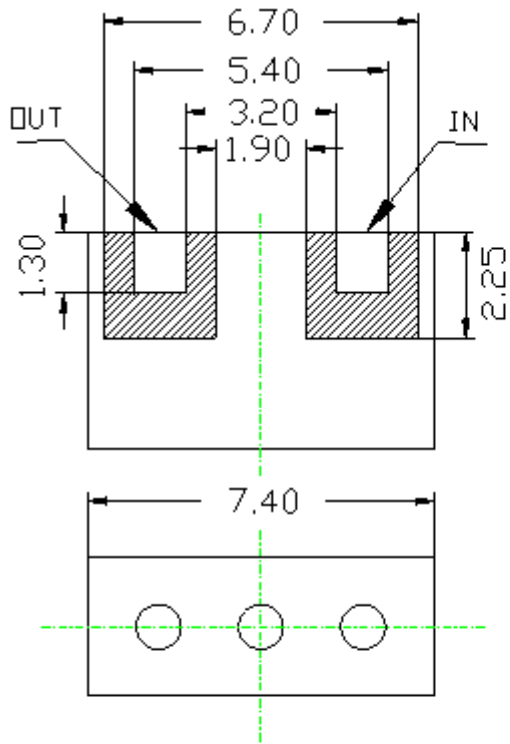

CIRDCMM : product name
 250C
 03 : month
 14 : year (2014)

Unit:mm
 Tolerance:±0.2

E. PCB Footprint:

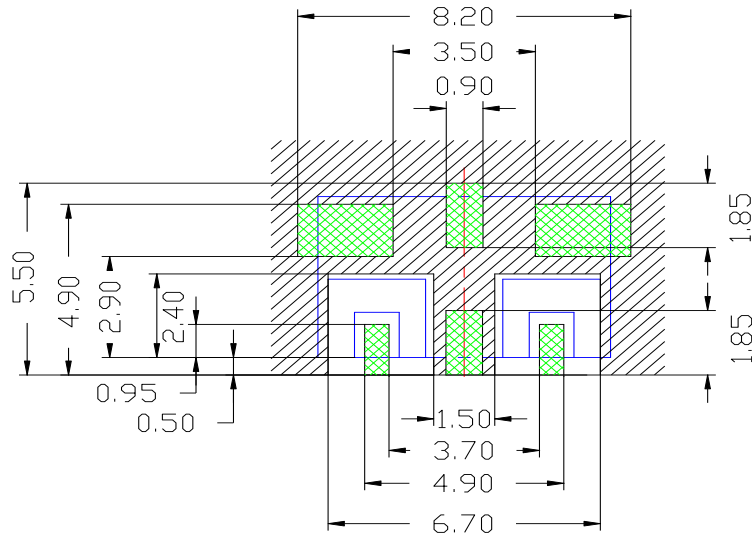

Tolerance: ± 0.15

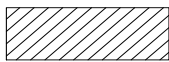

Conductive Material:
Ground, connected to
lower ground diameter of
0.3mm and max. distance
of 1.0mm



I/O Pads and LAND
I/O must be connected to lines with

50 Ω impedance.
in the application a
termination of 50 Ω
must be realized.



Solder Resist Without
Pattern

F.Packing:

1.Reel Dimension:

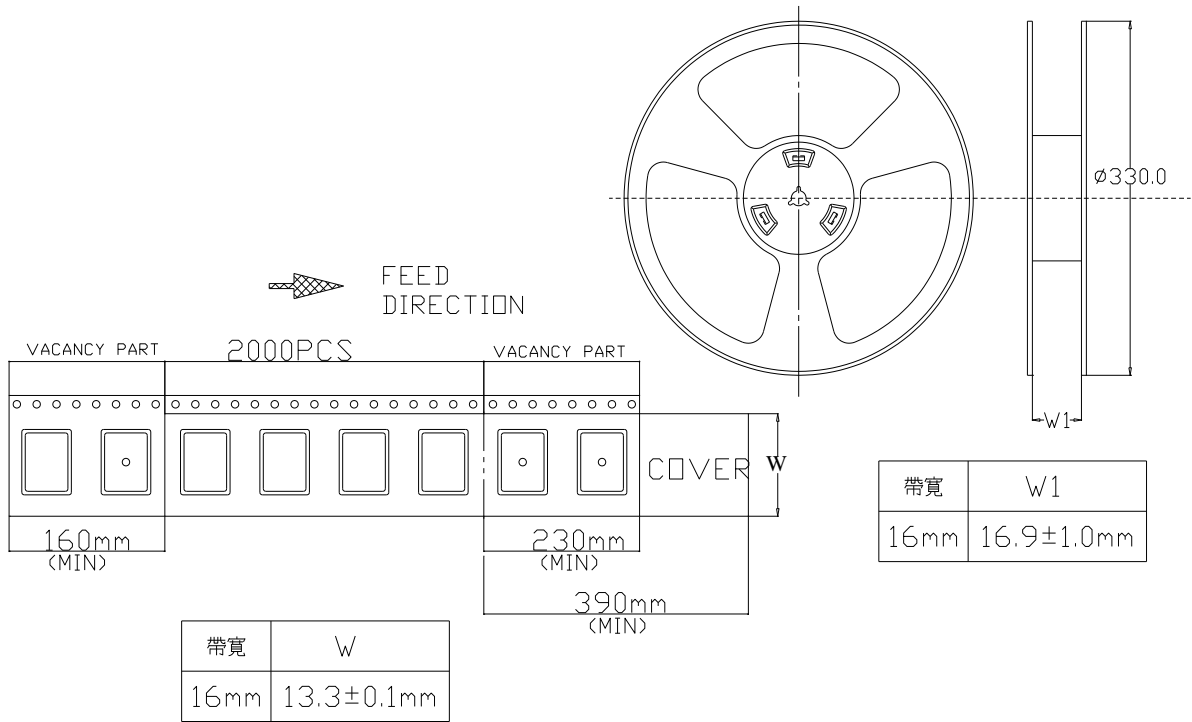

2.Tape Dimension:

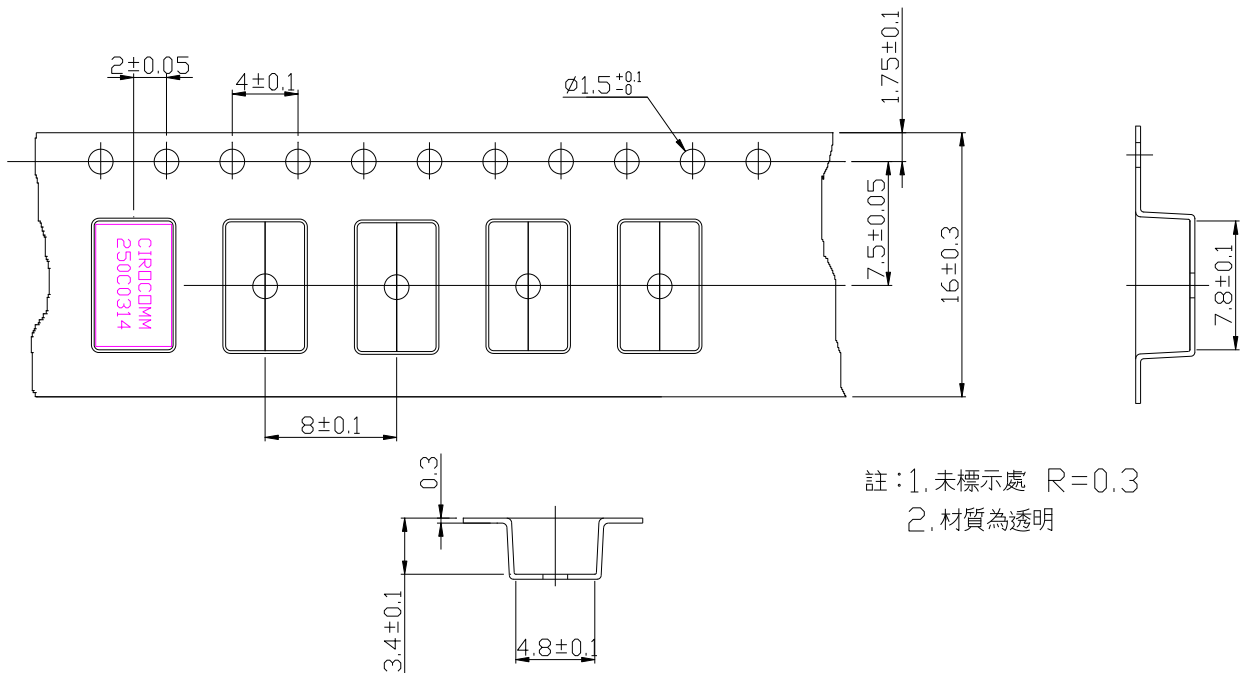

3.Package style:

1. Outer Carton

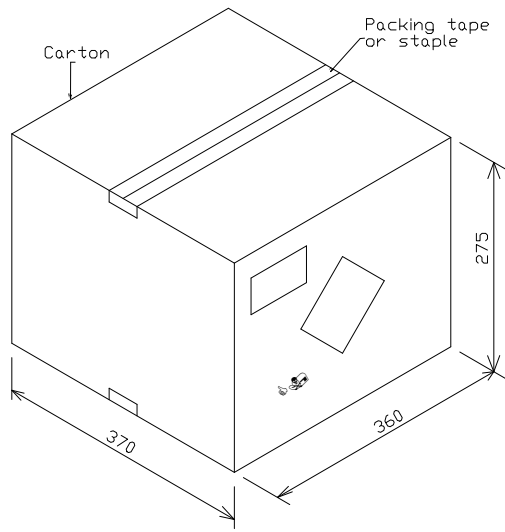

2. Inner Carton

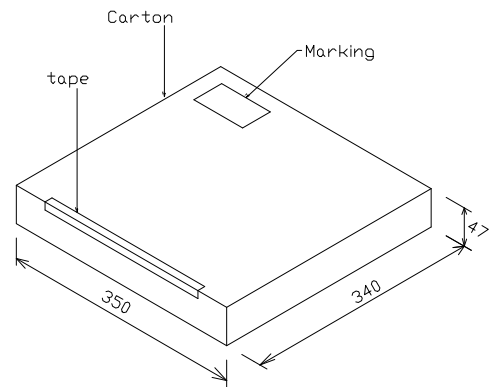

3. Bag

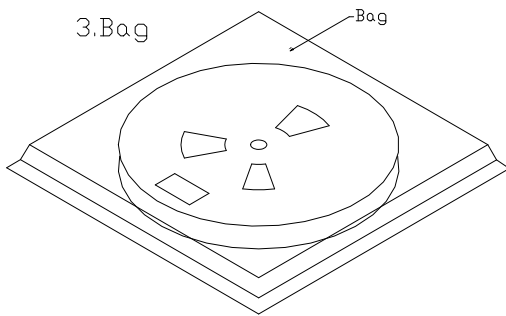

4. Taping

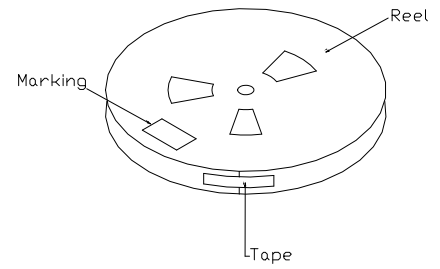

Unit:mm

G. Recommended Reflow Profile:

The recommended reflow soldering condition is shown in following figure. The temperature should be the temperature at the device.

	Profile for eutectic SnPb solder paste	Profile for leadfree solder paste	
Soldering type (measuring point on top surface of the component)	reflow 230 (max. 10 sec.)	reflow 260 (max. 3 sec.)	°C
Composition of solder paste	62Sn/36Pb/2Ag	96.5Sn/3Ag/0.5Cu	

